

Volume Down | Lautstärke verringern | Baisser volume | Abbassa il volume

Media | Medium | Media | Elementi multimediali

Mobile / Intercom | Handy / Gegensprechanlage | Téléphone / Interphone | Telefono / Interfono

Volume Up | Lautstärke erhöhen | Augmenter volume | Alza il volume

LED Indicator | LED-Anzeige | Voyant LED | Indicatore LED

X1 Tap | Number of Taps | Anzahl der Tipps | Nombre de clics | Numero di tocchi

2 Sec | Press & Hold | Gedrückt halten | Appuyez & Maintenez | Tieni premuto

On / Off | Ein / Aus | On / Off | Acceso/Spento

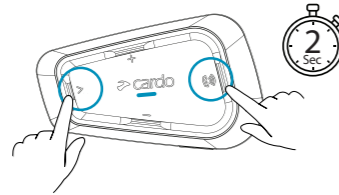

Phone Pairing | Telefon-Kopplung | Appairage au téléphone | Abbinamento telefono

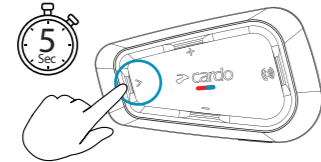

LED Red & Blue | LED Rot und Grün | LED Rouge & Bleu | LED rosso e blu

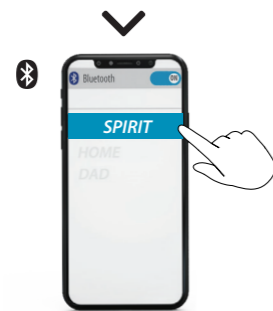

Download | Download | Télécharger | Scarica



R Register | Registrieren | S'enregistrer | Registrati

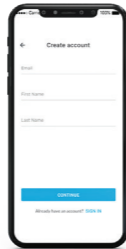

Choose Language | Sprache auswählen | Choisir langue | Scegli la lingua



Software Update | Software Update | Actualisation du logiciel | Aggiornamento software

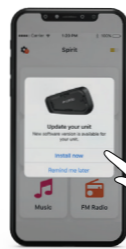

Volume Up | Lautstärke erhöhen | Augmenter le volume | Alza il volume

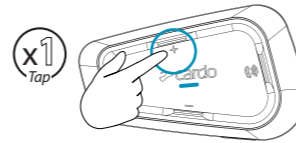

Volume Down | Lautstärke verringern | Baisser le volume | Abbassa il volume



Mute | Stummschalten | Silence | Silenzia

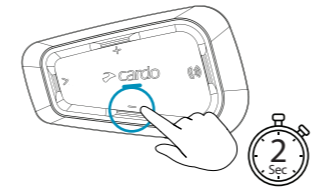

Voice Assistant | Sprachassistent | Assistant vocal | Assistente vocale

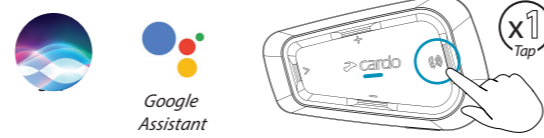

Answer | Antworten | Répondre | Rispondi



Ignore | Ignorieren | Ignorer | Ignora



End Call | Anruf beenden | Raccrocher | Termina chiamata

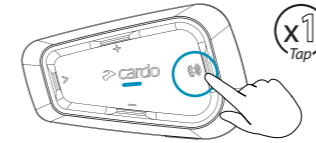

Speed Dial | Kurzwahl | Numérotation rapide | Composizione veloce

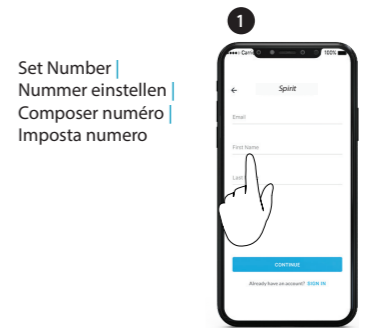

Set Number | Nummer einstellen | Composer numéro | Imposta numero

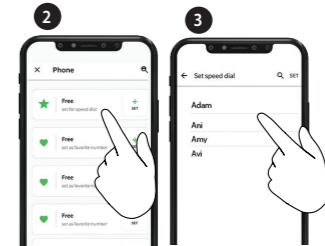

Call Speed Dial | Kurzwahl anwählen | Appel numérotation rapide | Chiama composizione veloce



cardosystems.com



cardosystems.com/update

cardosystems.com/support



▶ Play | Abspielen | Marche | Riproduci

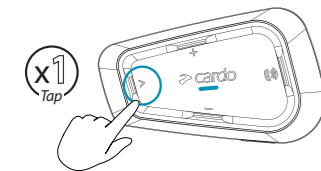

⏸ Pause | Pause | Pause | Pausa

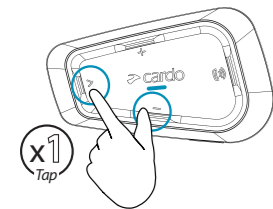

▶ Next | Weiter | Suivant | Successiva

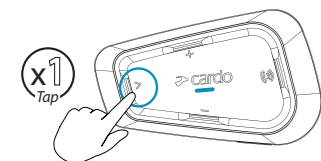

◀ Previous | Zurück | Précédent | Precedente

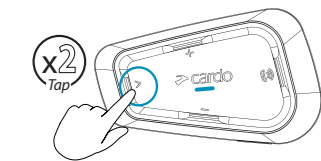

🔗 Pairing | Koppeln | Appairage | Accoppiamento

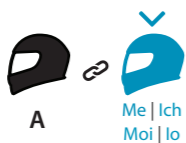

Pair to Rider A | Koppeln mit Fahrer A |
Appairer au motard A | Abbina a motociclista A

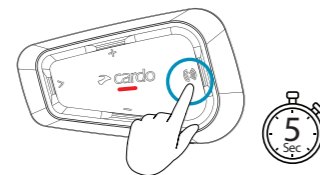

LED Red | LED Rot | LED Rouge | LED rosso

🗨 Call / End Intercom | Gegensprechanlage rufen / beenden |
Appeler/Raccrocher interphone | Chiama/Termina interfono

Rider A |
Fahrer A |
Motard A |
Motociclista A

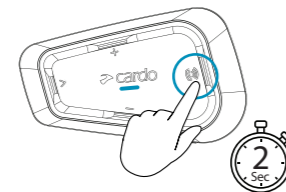

👤 Share | Freigeben | Partager | Condividi

🎵 Share Music | Musik freigeben | Partager musique | Condividi musica

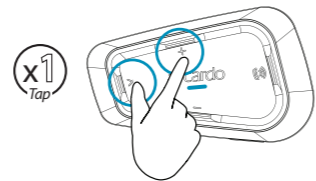

☎ Share Phone Call | Telefongespräch freigeben | Partager appel |
Condividi telefonata

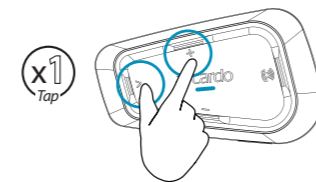

1 Step 1 | Schritt 1 | Étape 1 | Passo 1

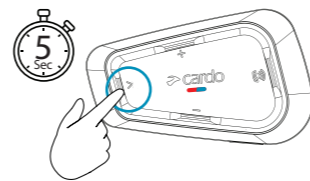

LED Red & Blue | LED Rot und Grün |
LED Rouge & Bleu | LED rosso e blu

2 Step 2 | Schritt 2 | Étape 2 | Passo 2

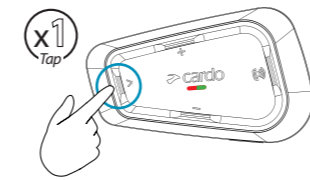

LED Red & Green | LED Rot und Grün |
LED Rouge & Vert | LED rosso e verde

3 Step 3 | Schritt 3 | Étape 3 | Passo 3



DOWNLOAD cardo CONNECT APP



- Over-The-Air Update
- Control Your Unit
- Setup & Setting



Cardo Connect App



SPIRIT POCKET GUIDE EN/DE/FR/IT

