



CARDO
FREECOM 4x

.....
KURZANLEITUNG

DE



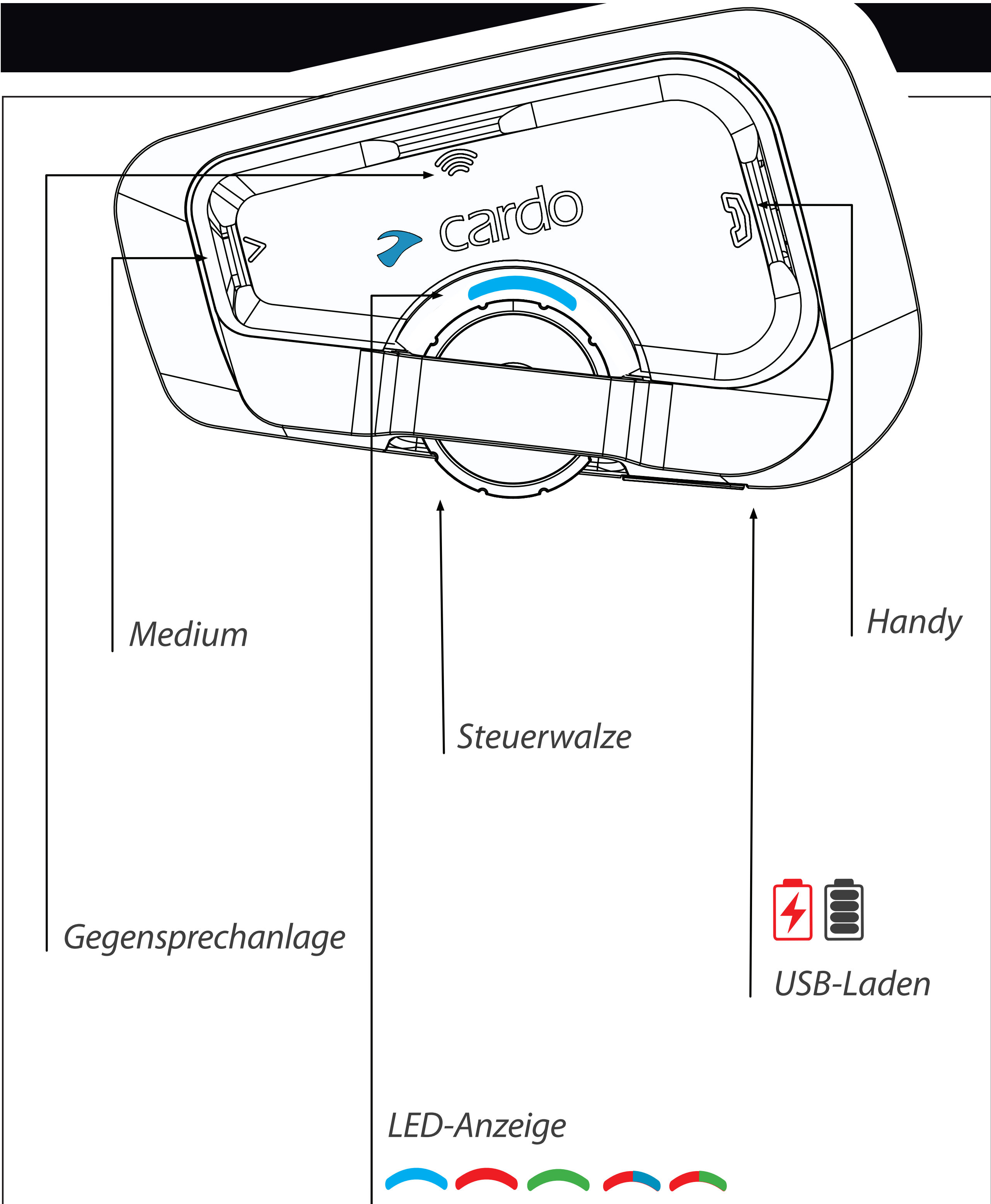

Gedrückt halten



Anzahl der Tipps

Erste Schritte

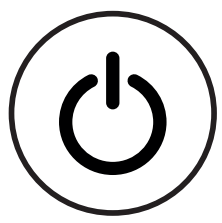

Ein / Aus

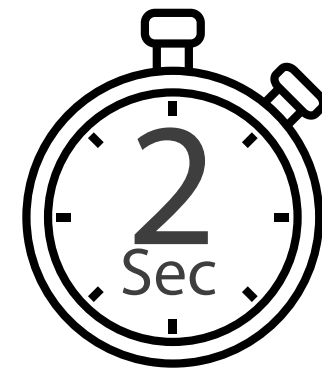
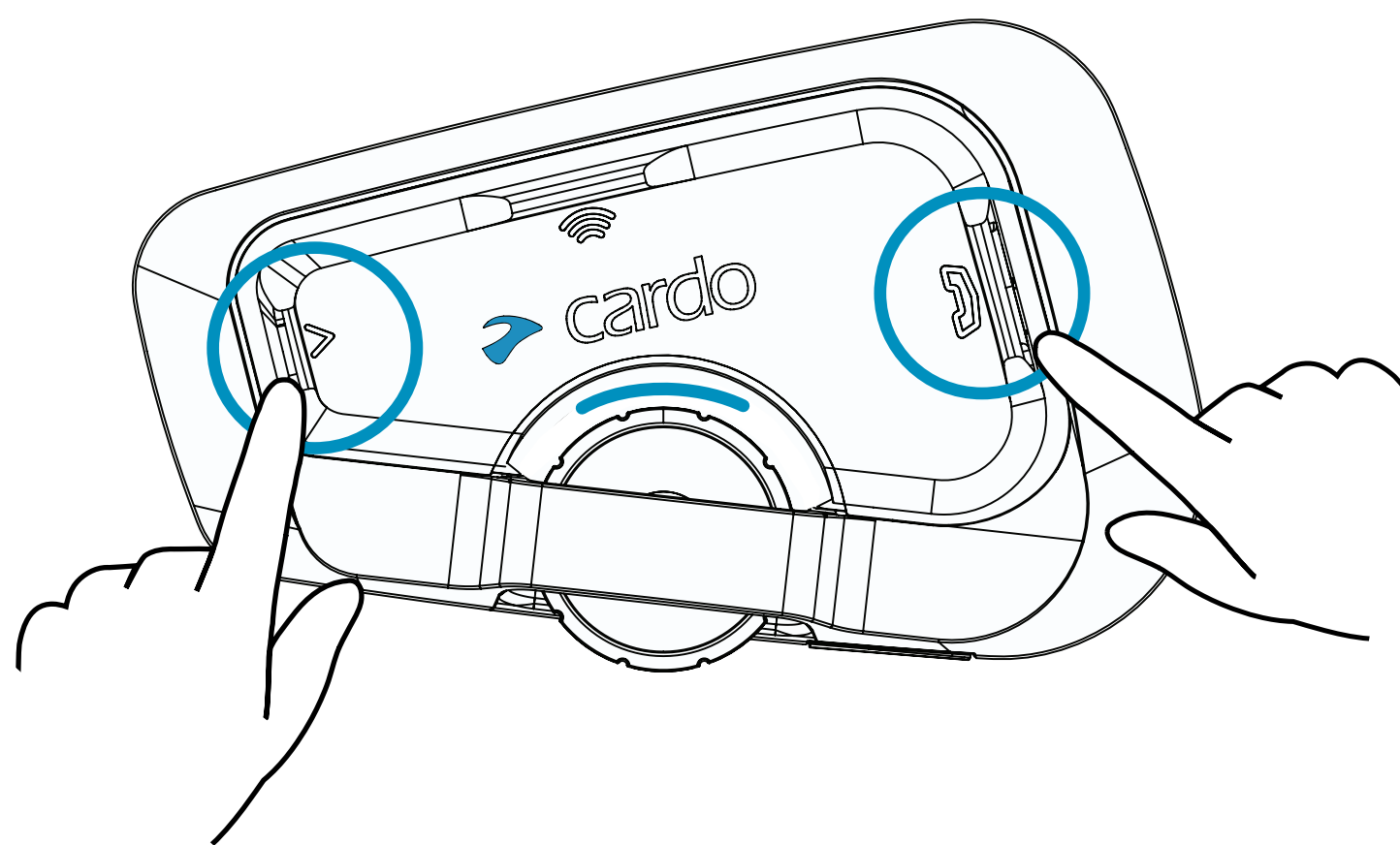

Telefon-Kopplung

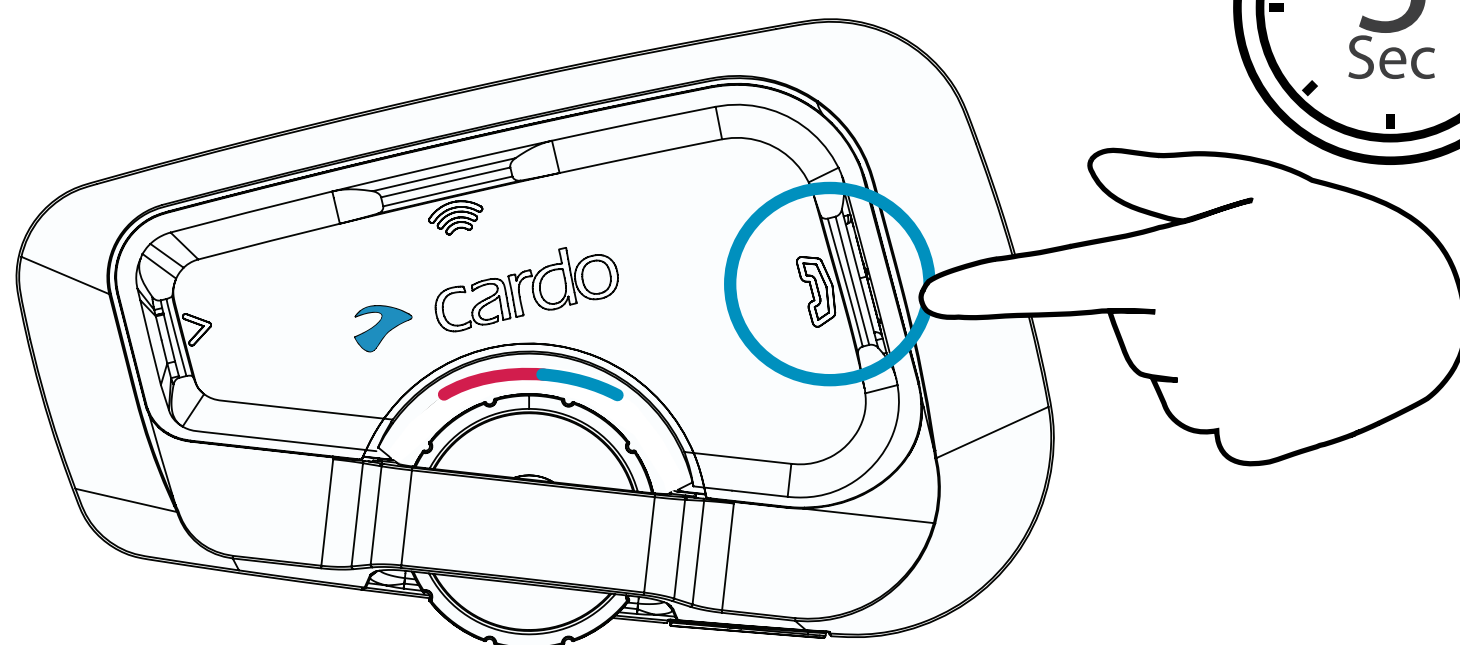

LED Rot und Blau



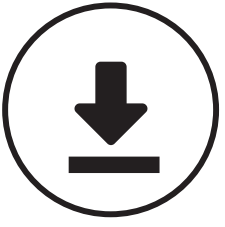

Download



Registrieren

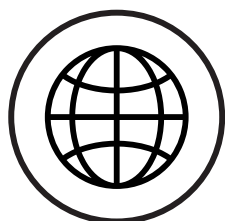
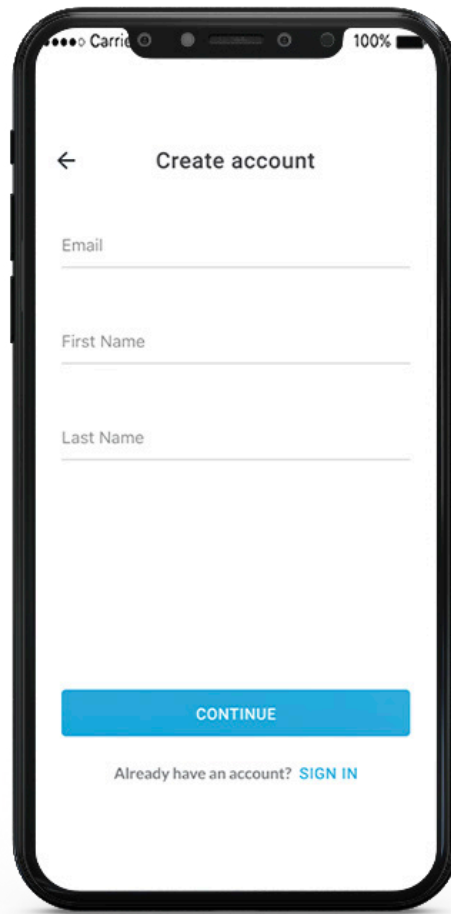

Sprache auswählen

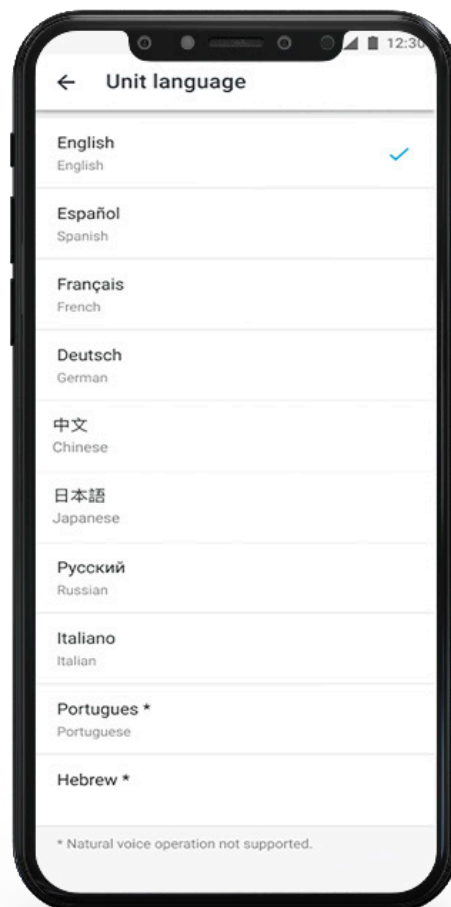

Software Update

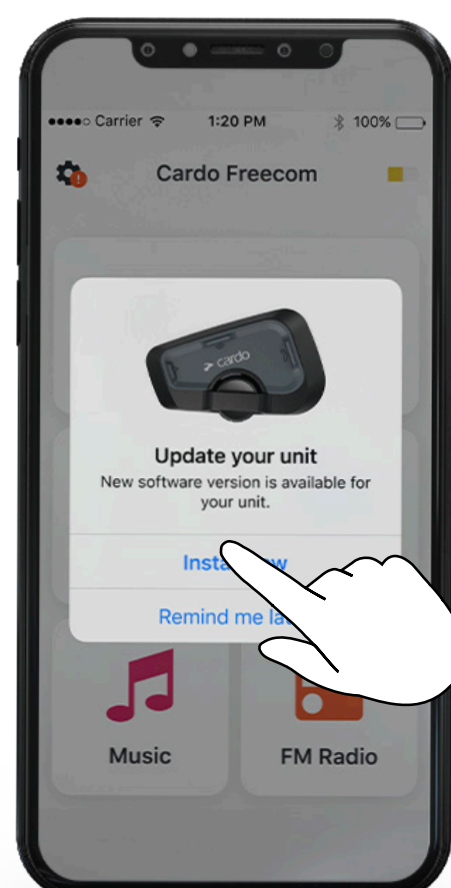

Allgemein

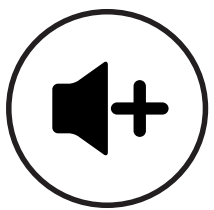

Lautstärke erhöhen

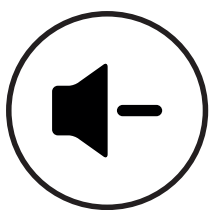

Lautstärke verringern

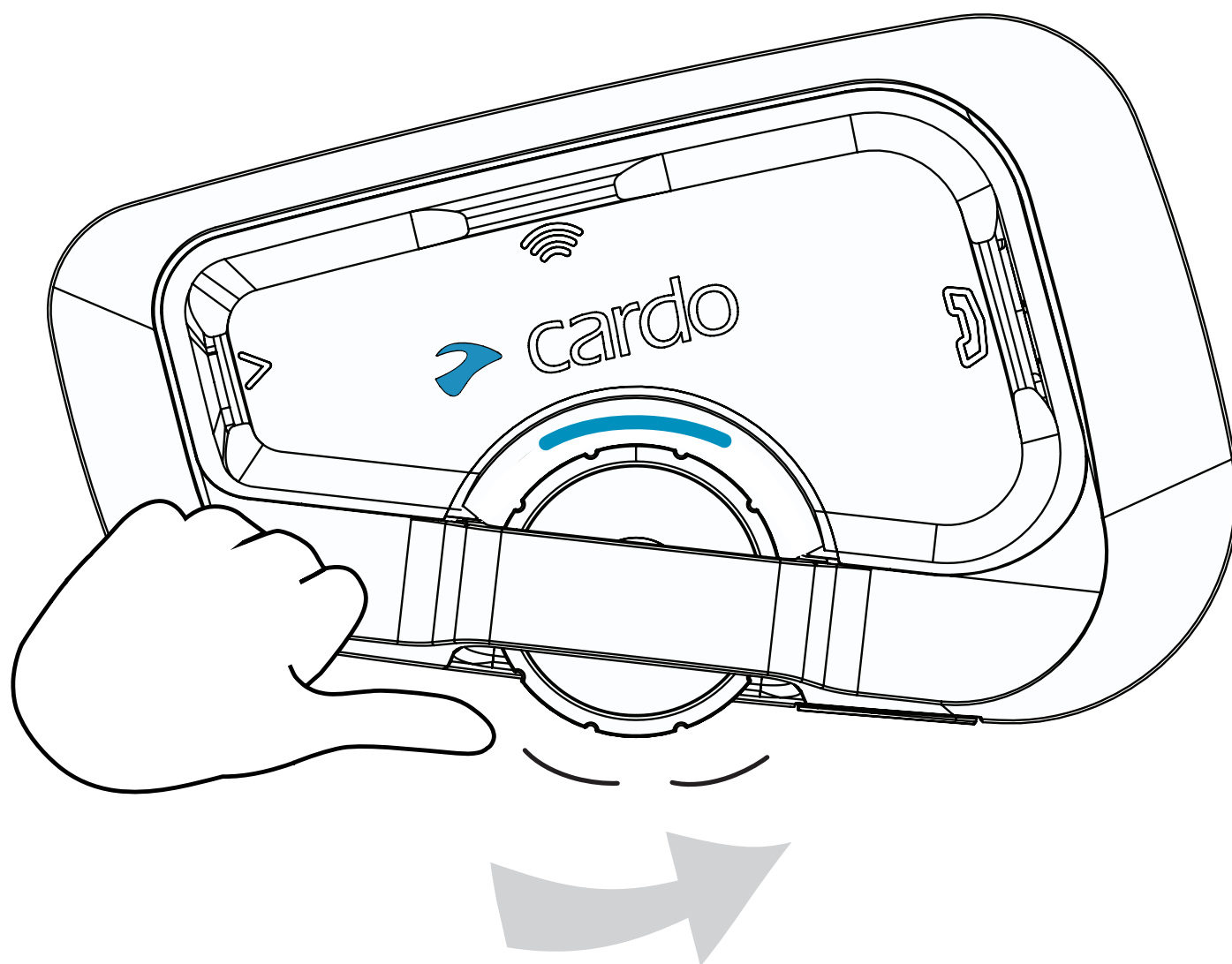

Sprachassistent

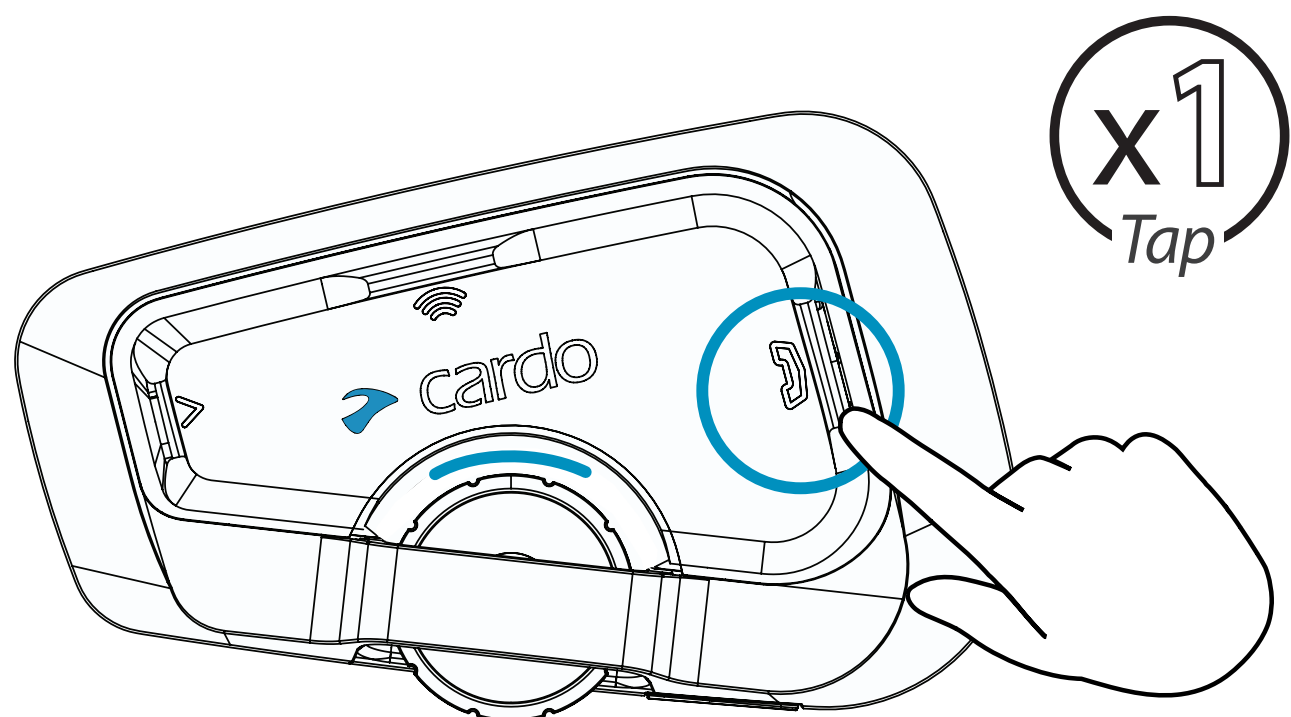

Musik



Abspielen

x1
Tap

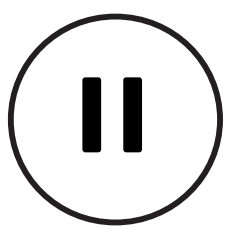
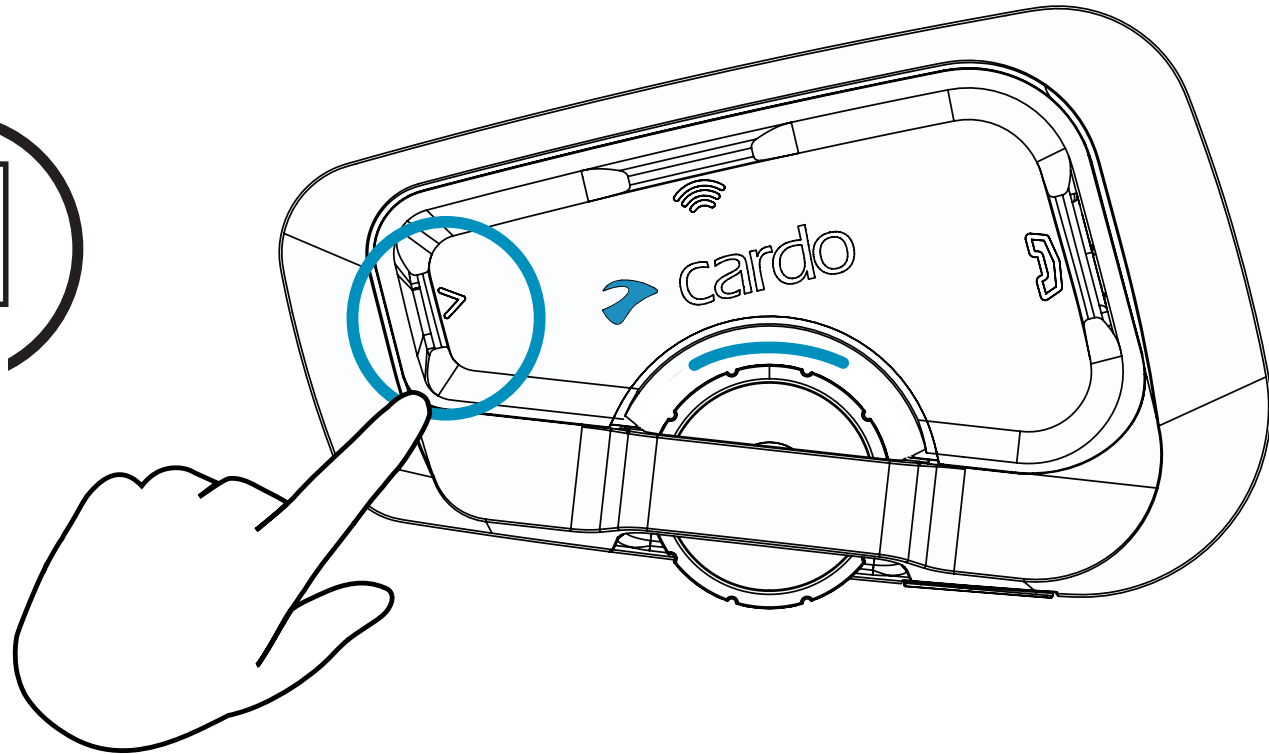

Pause

x1
Tap

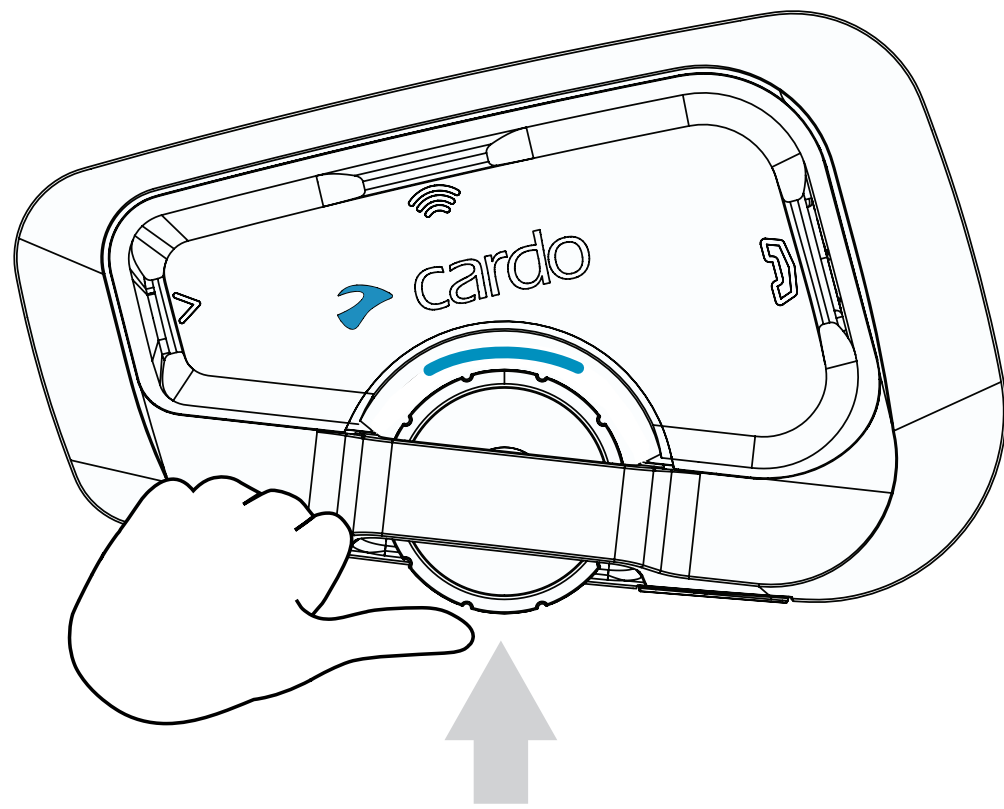

Weiter

x1
Tap

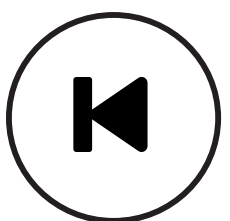
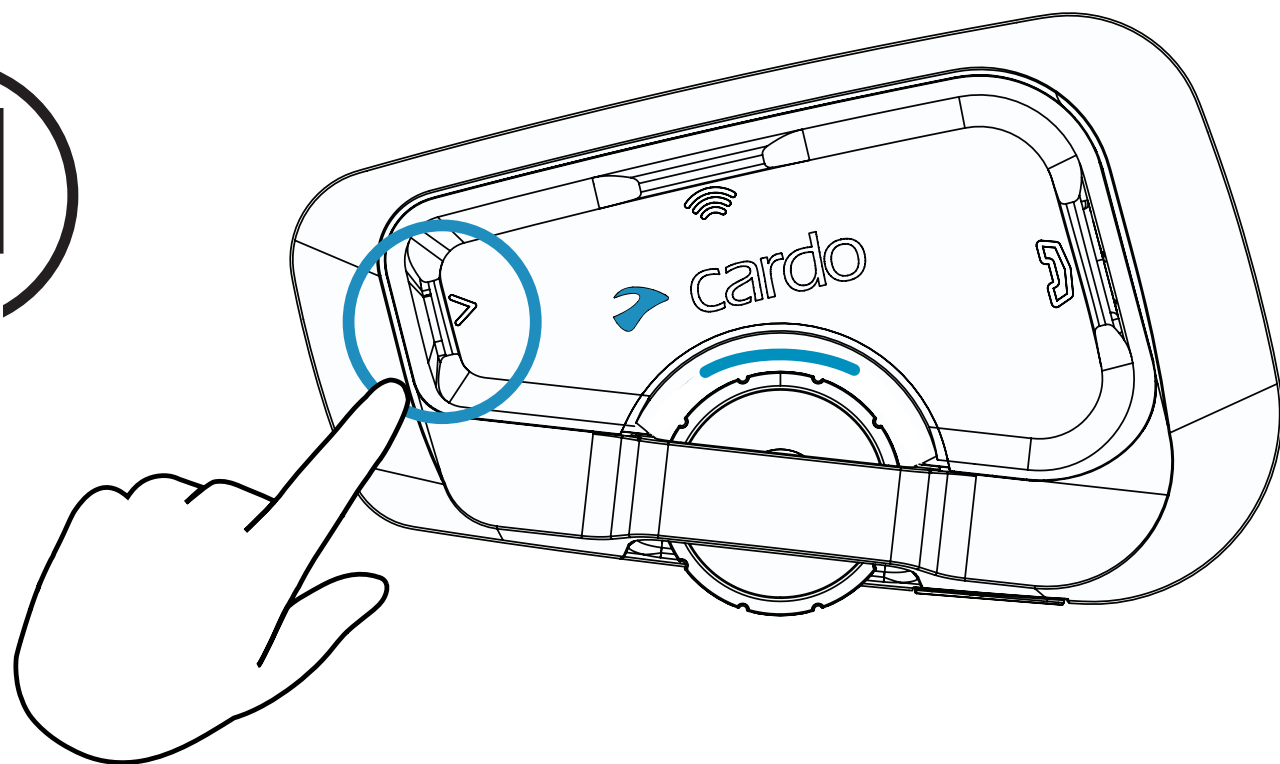

Zurück

x2
Tap

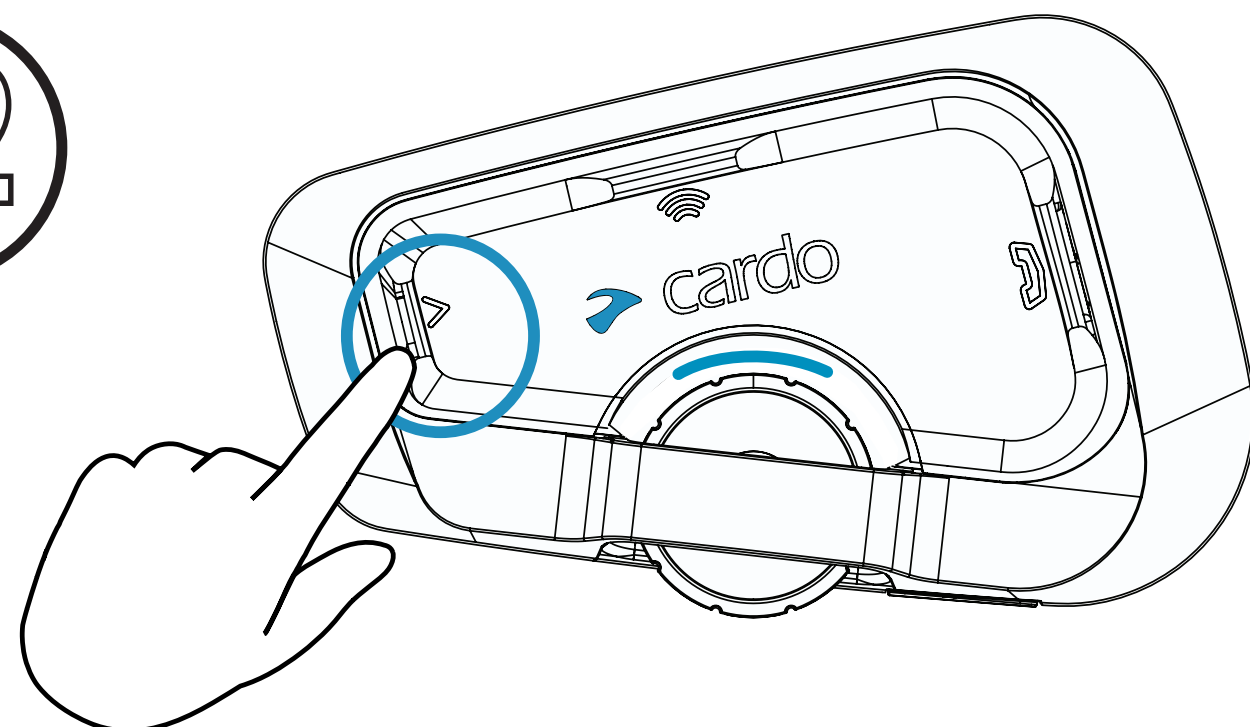

Radio



Voreinstellungen festlegen

1

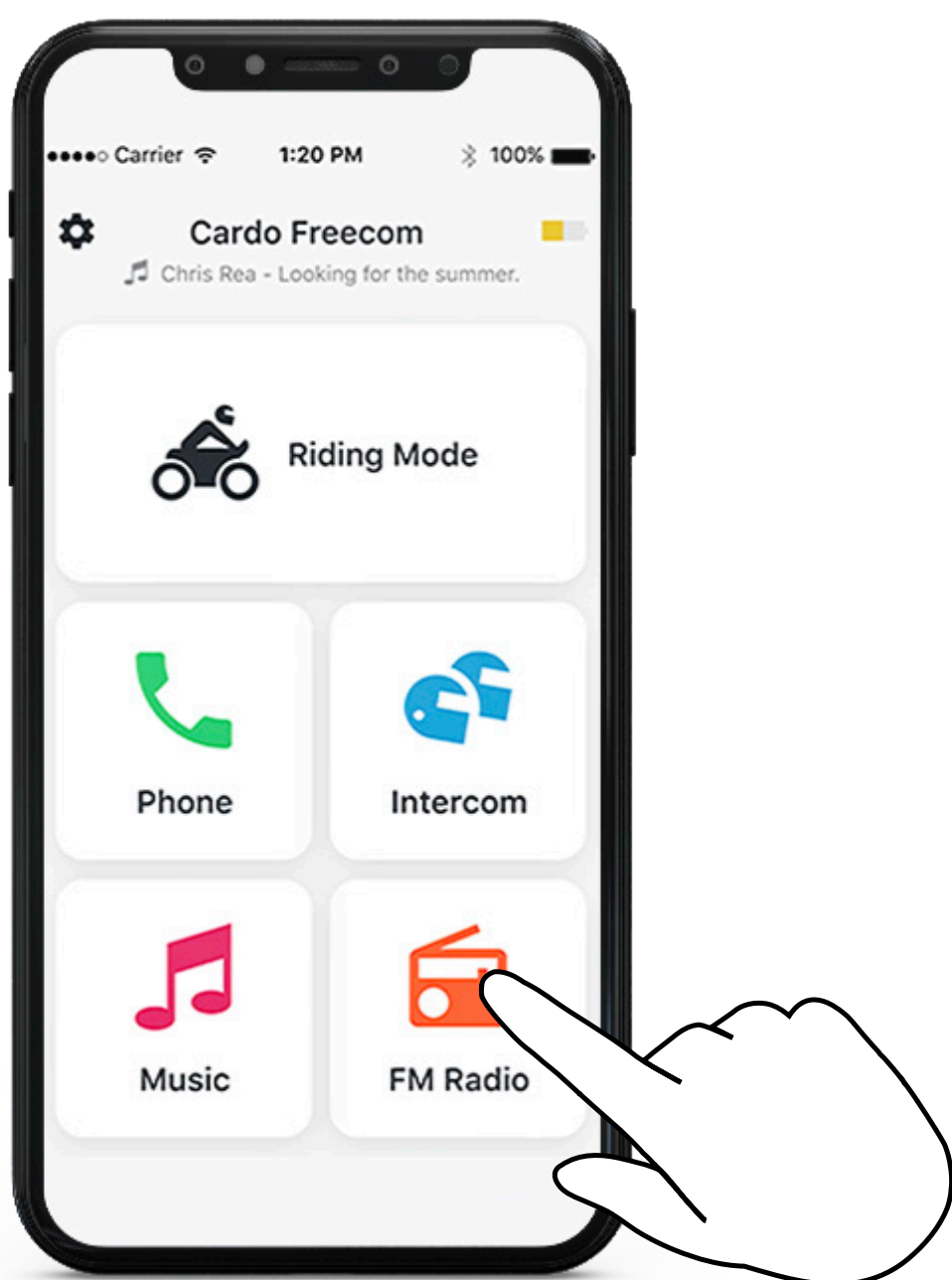

2

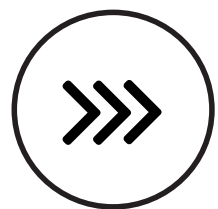
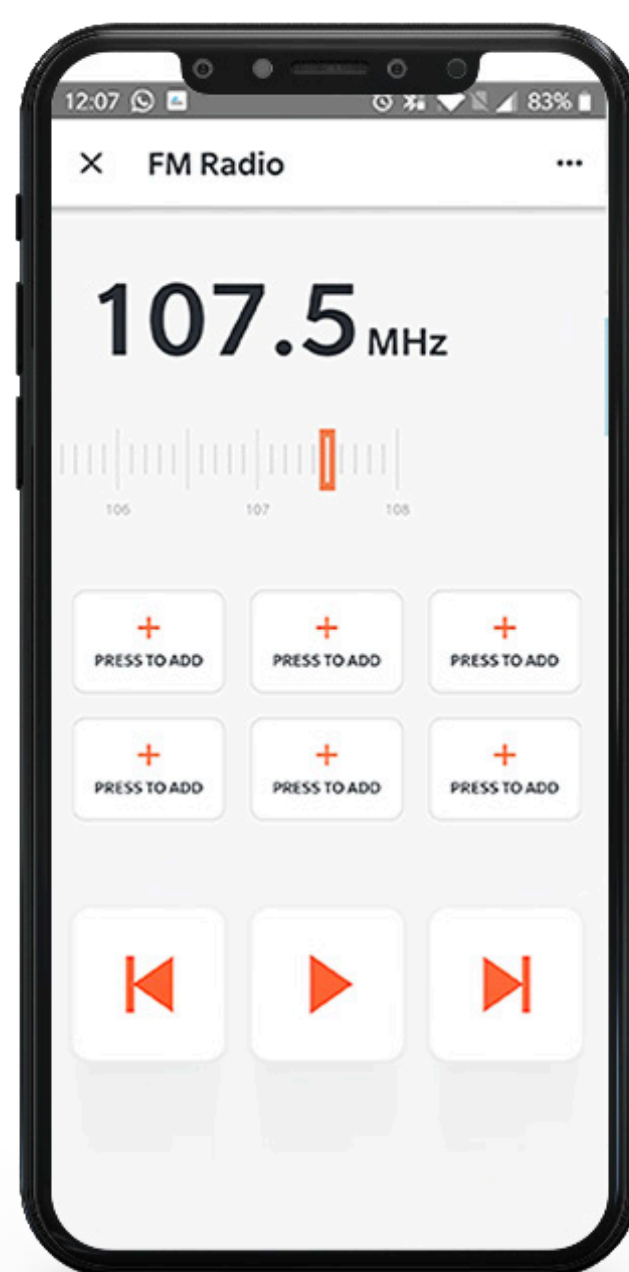

Suchlauf starten

X3
Tap

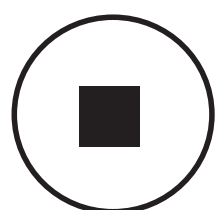
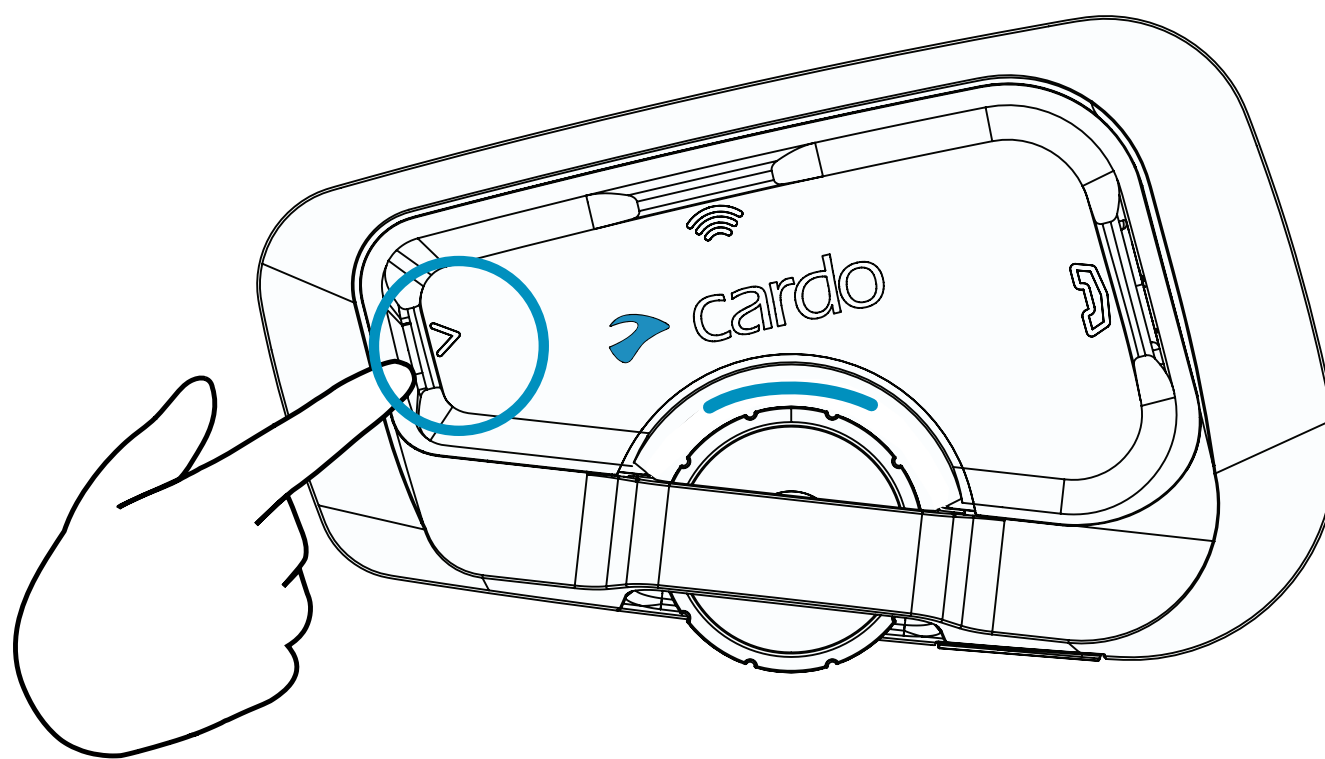

Suchlauf beenden

X1
Tap

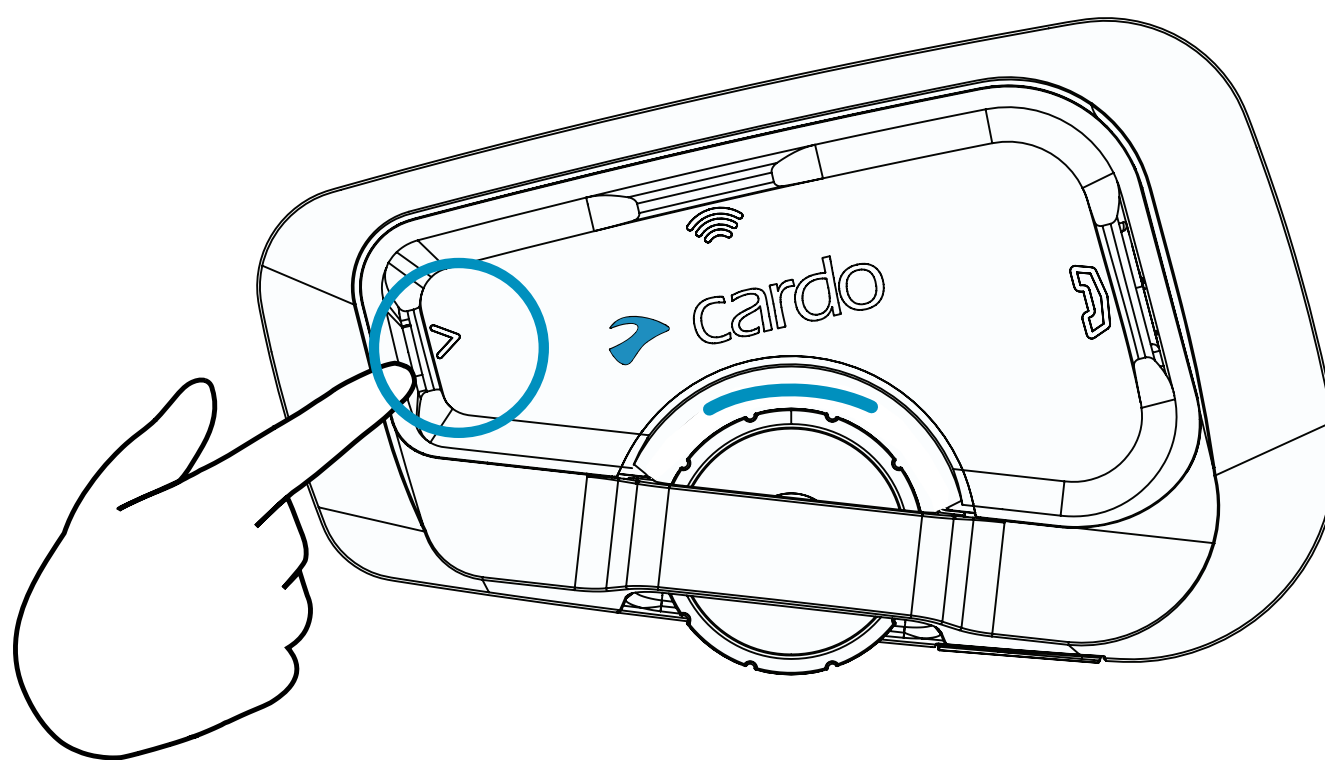

Radio



Ein

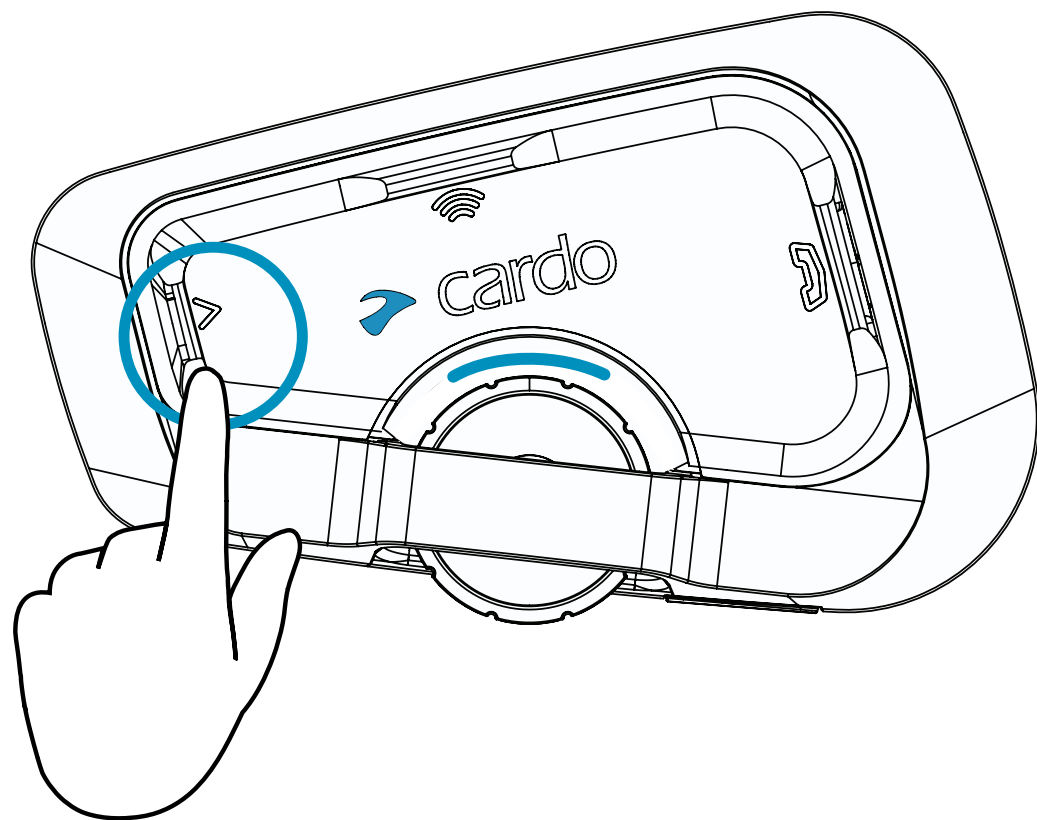

Aus

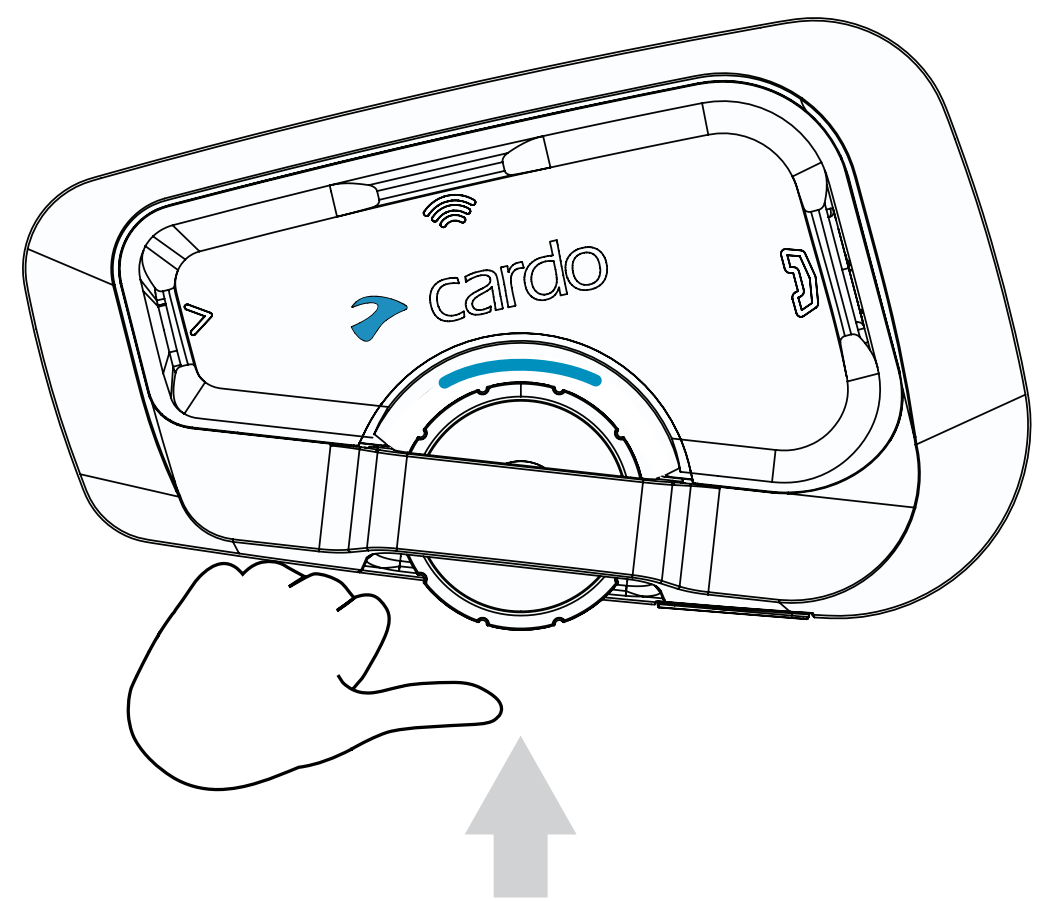

Nächste Voreinstellung

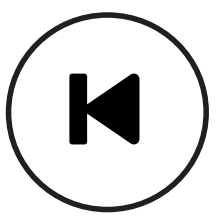
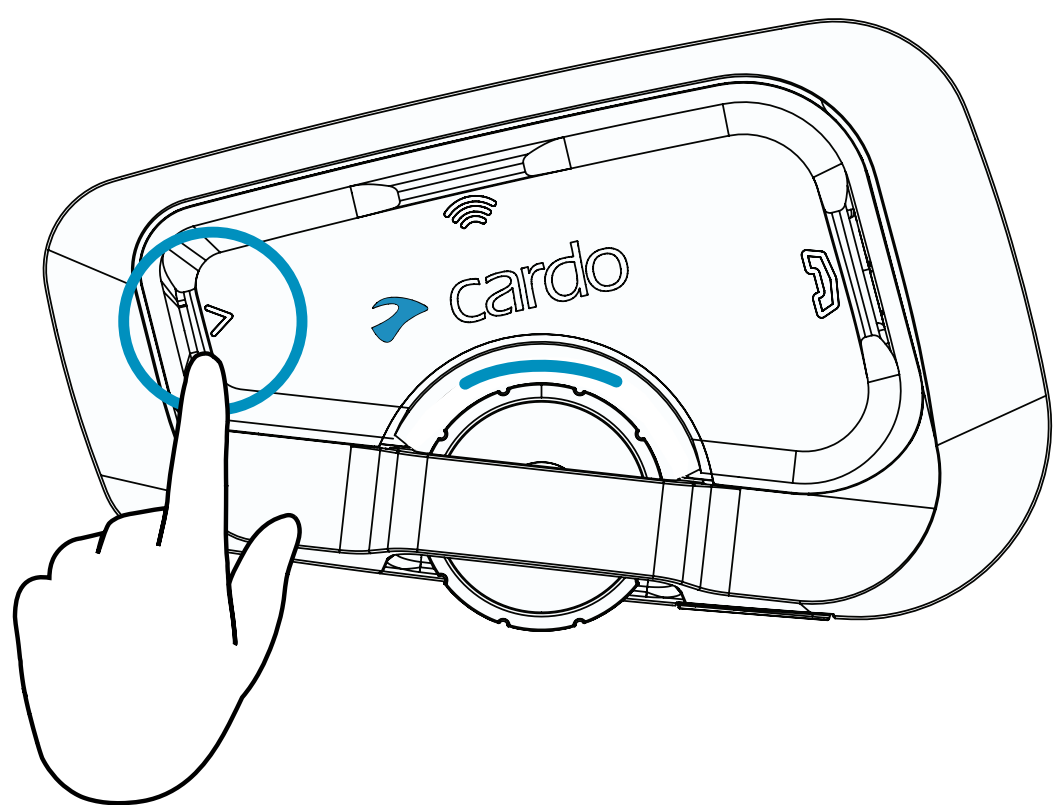

Frühere Voreinstellung

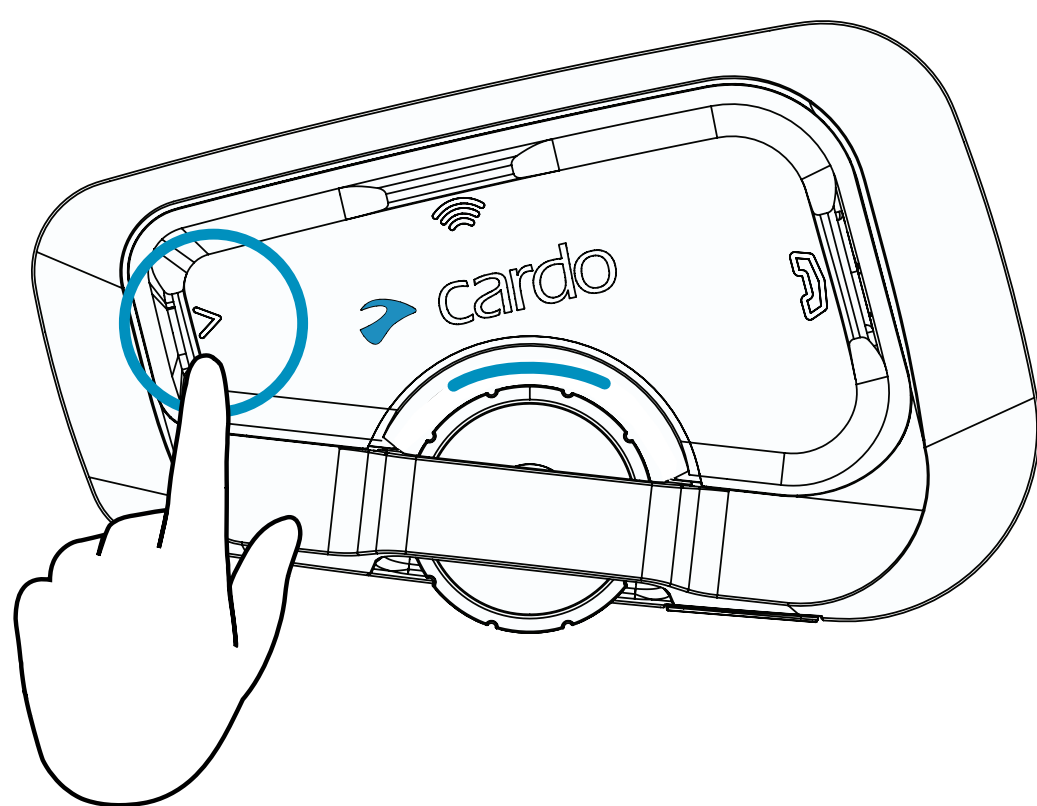

Quelle wechseln



Musik zu Radio

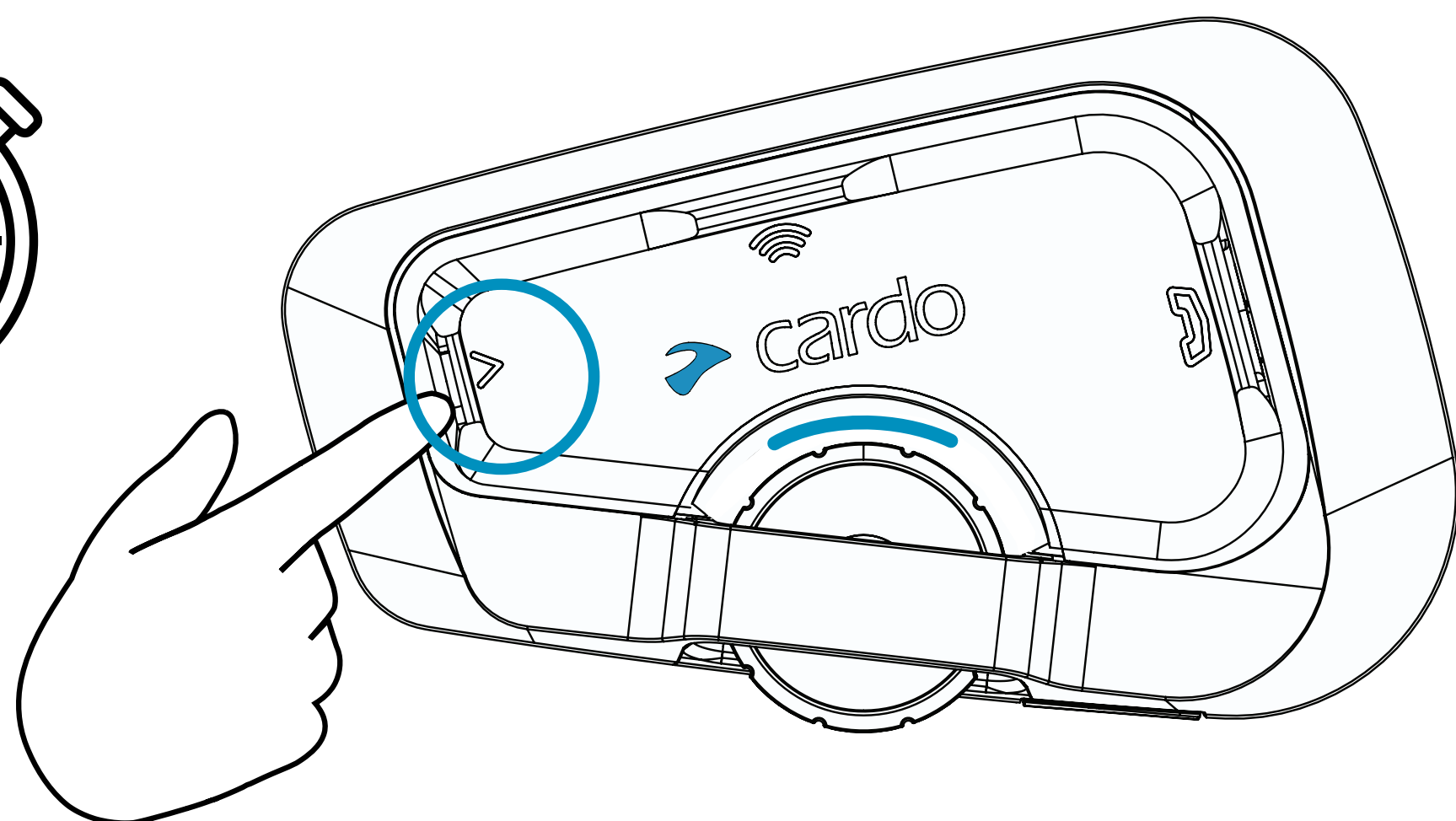

Radio zu Musik

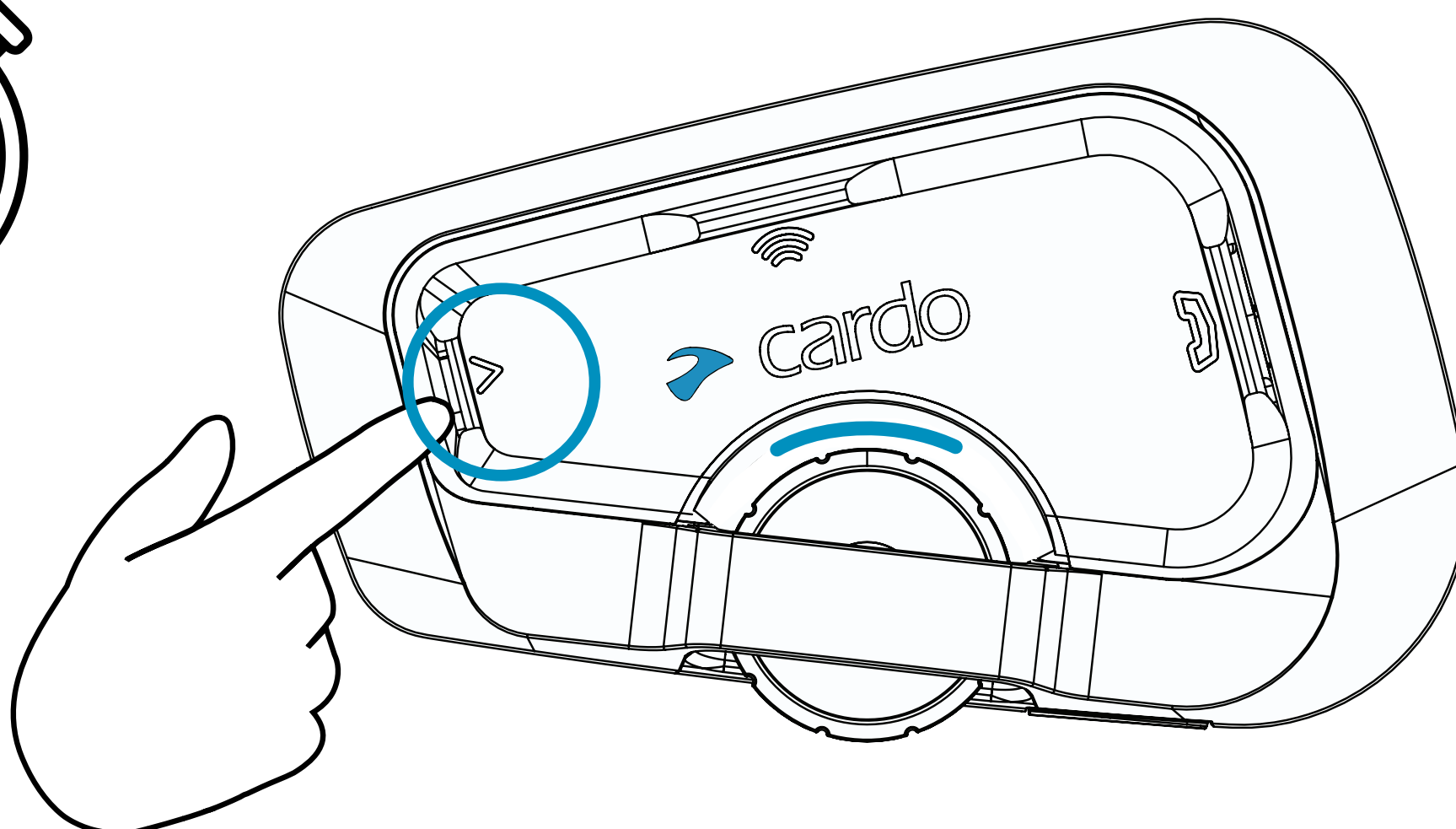

Telefongespräch



Antworten

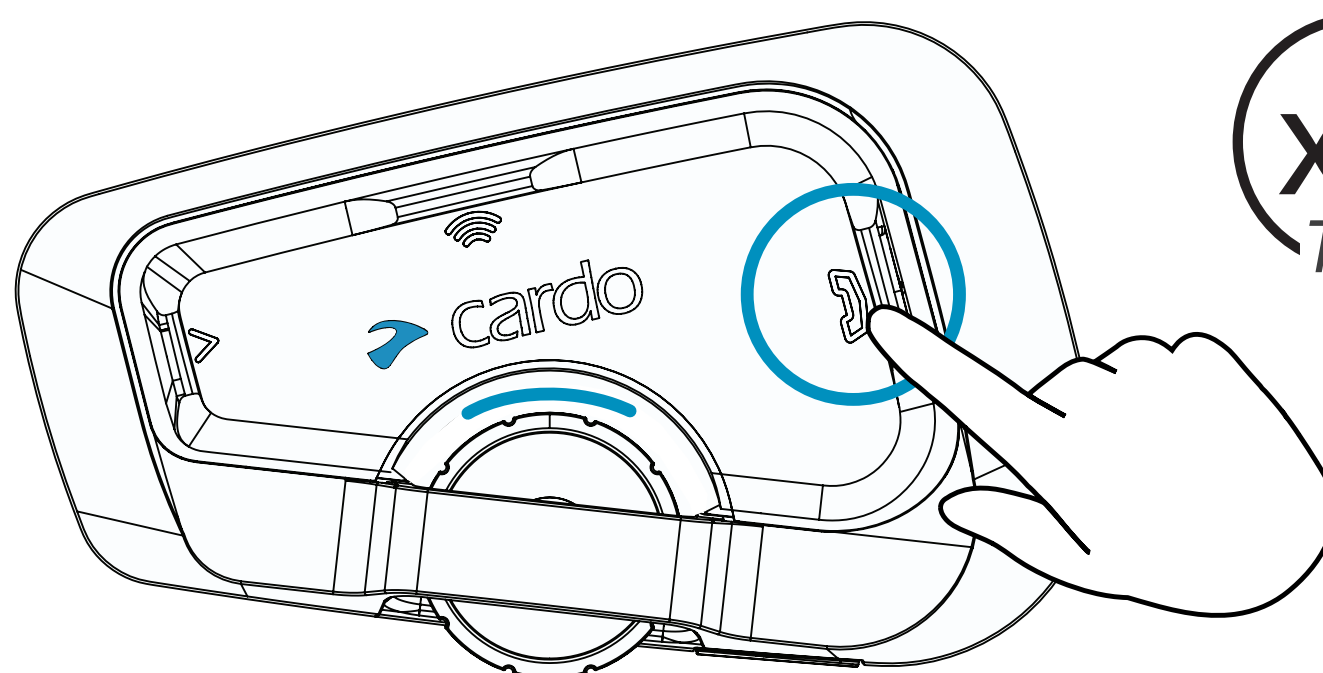

Ignorieren

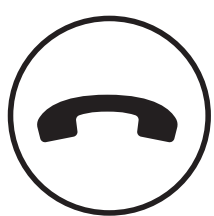
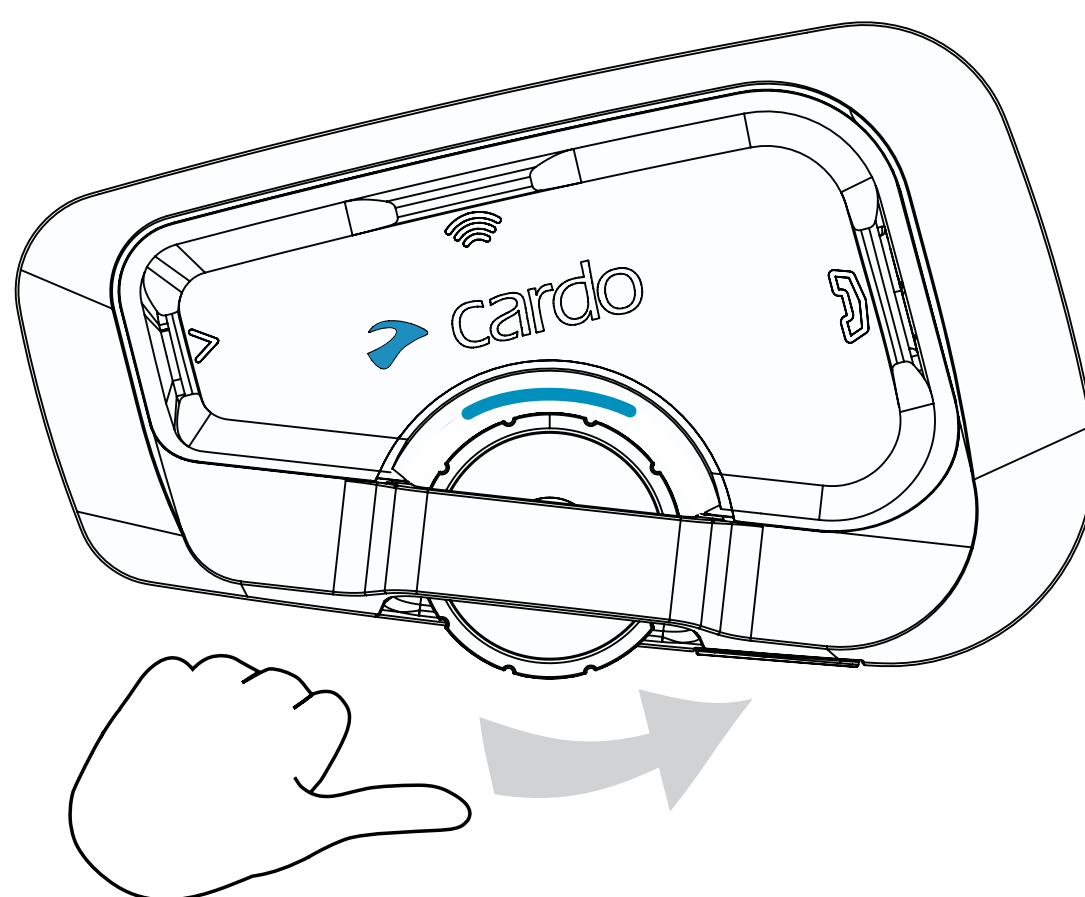

Anruf beenden

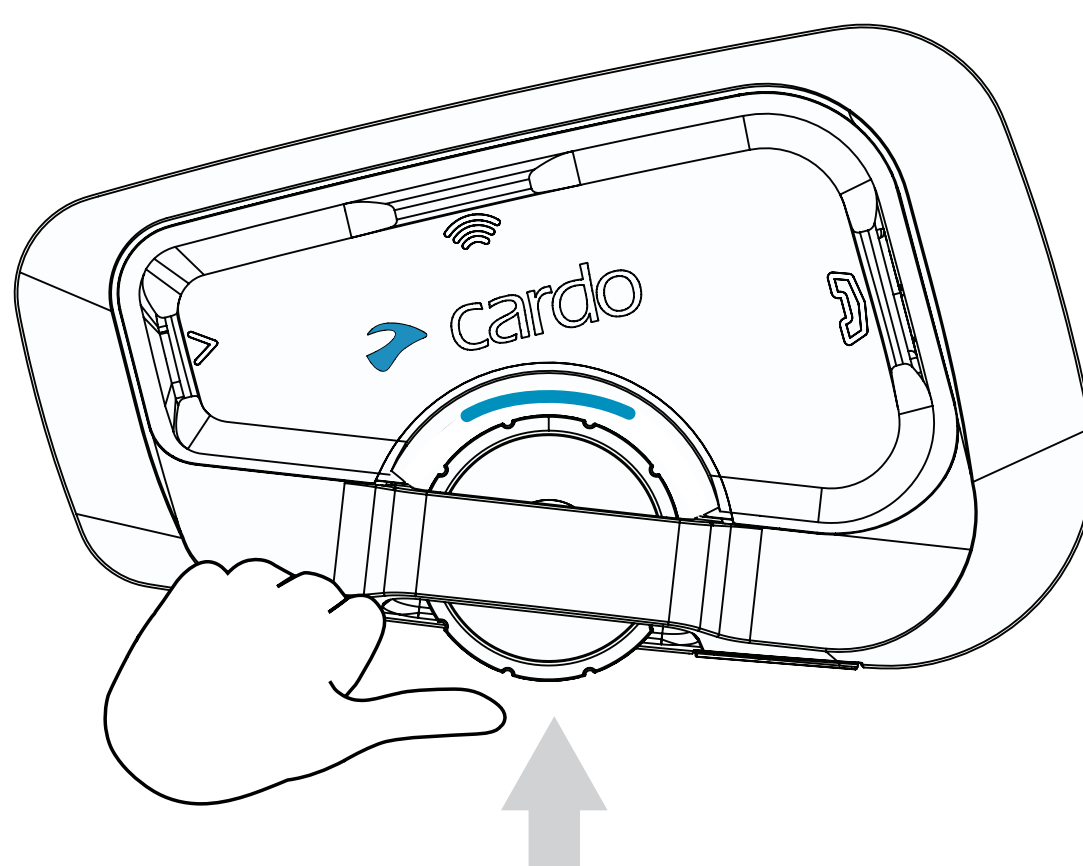

Wahl wiederholen

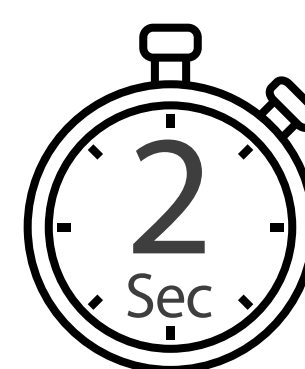
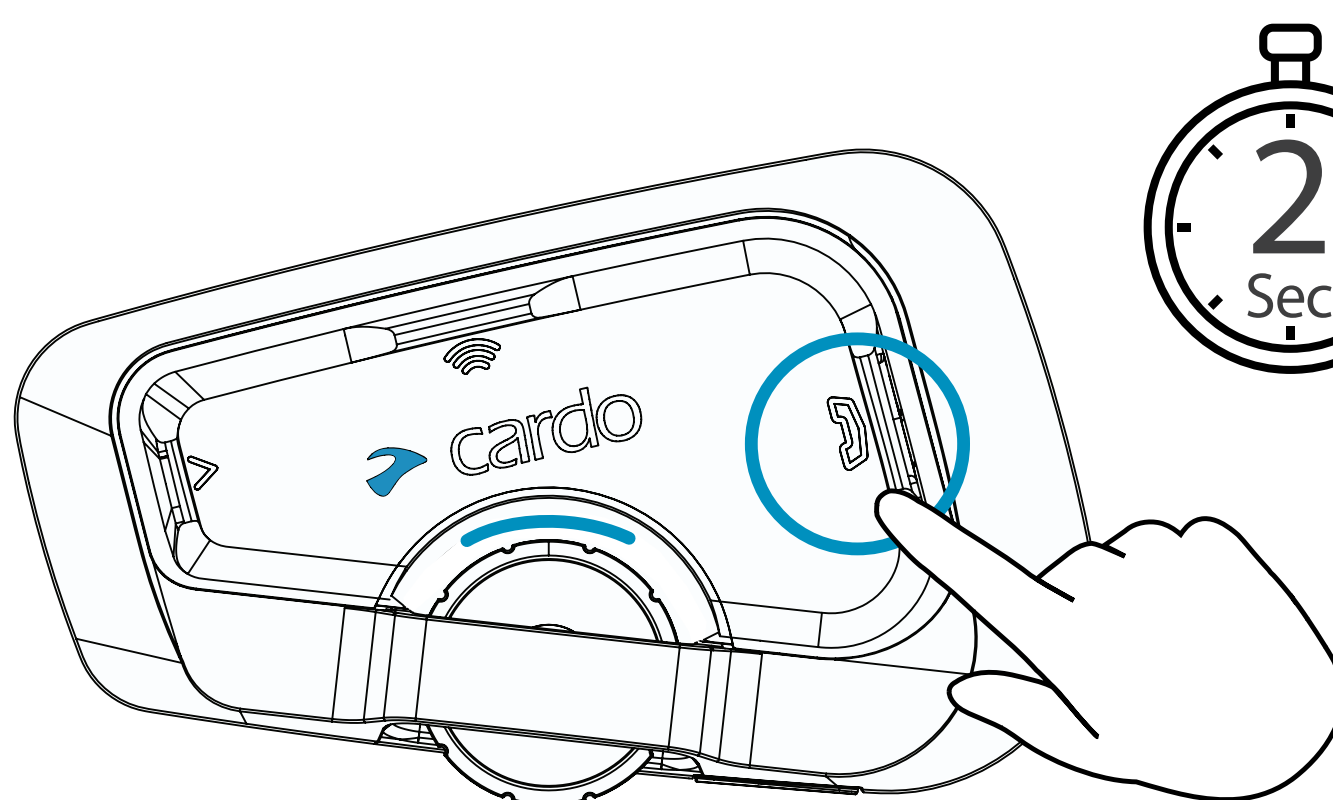

Telefongespräch



Kurzwahl

Nummer einstellen

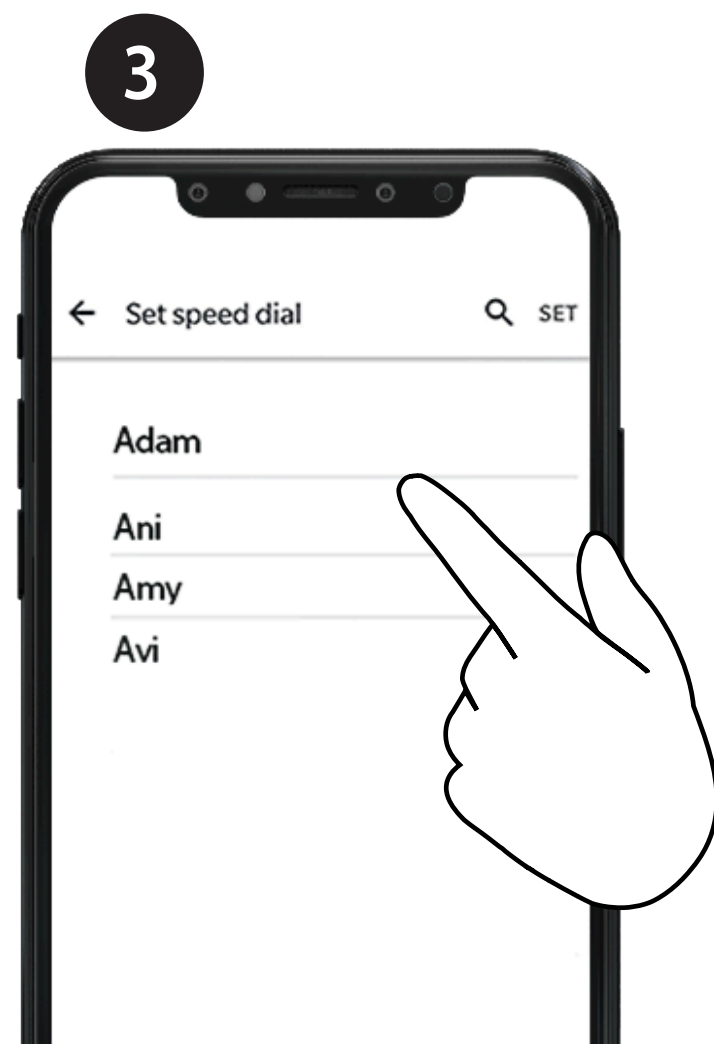
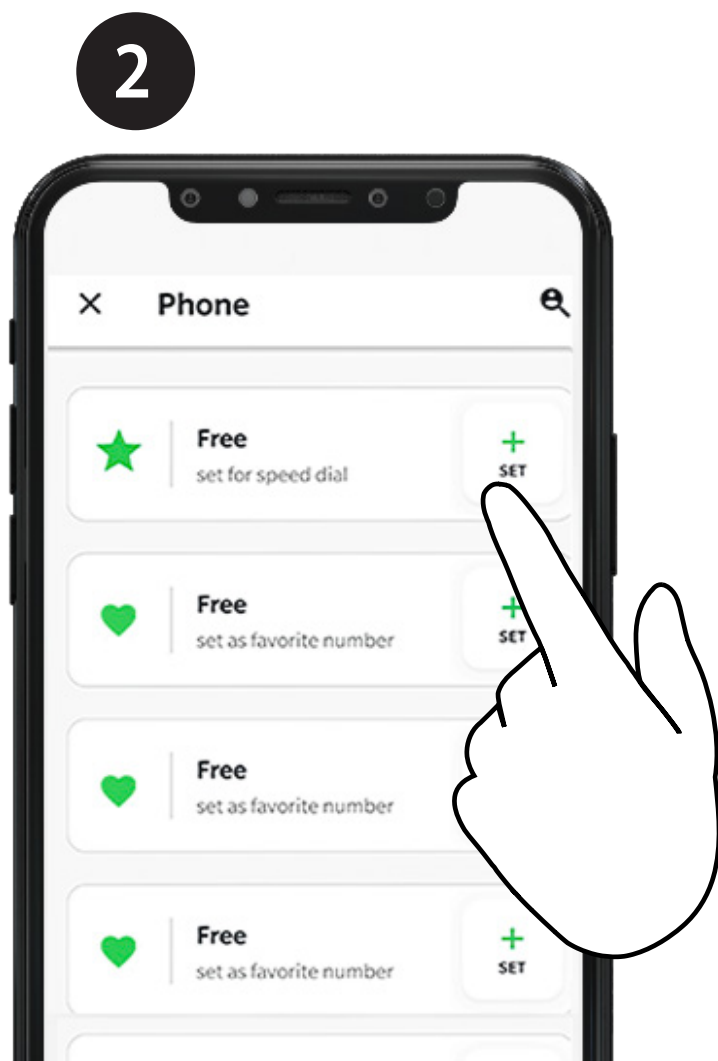
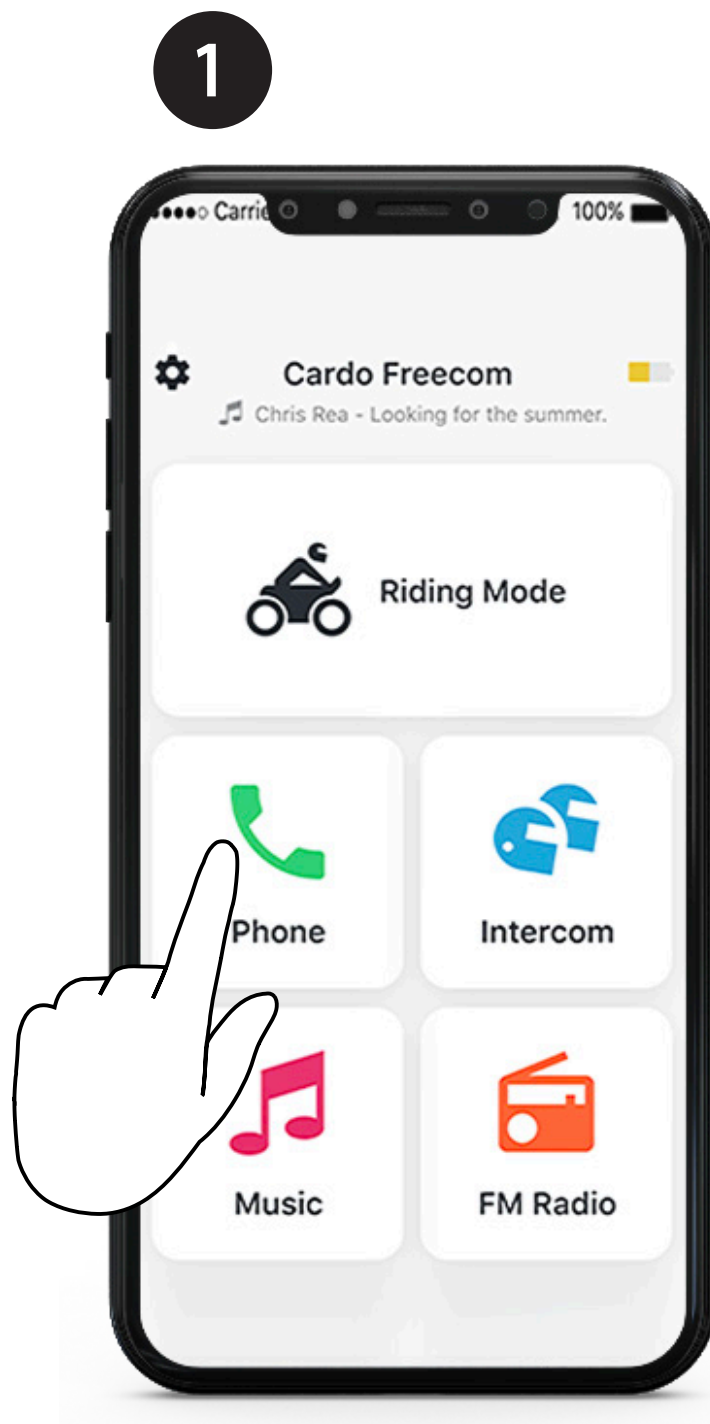

Kurzwahl anwählen

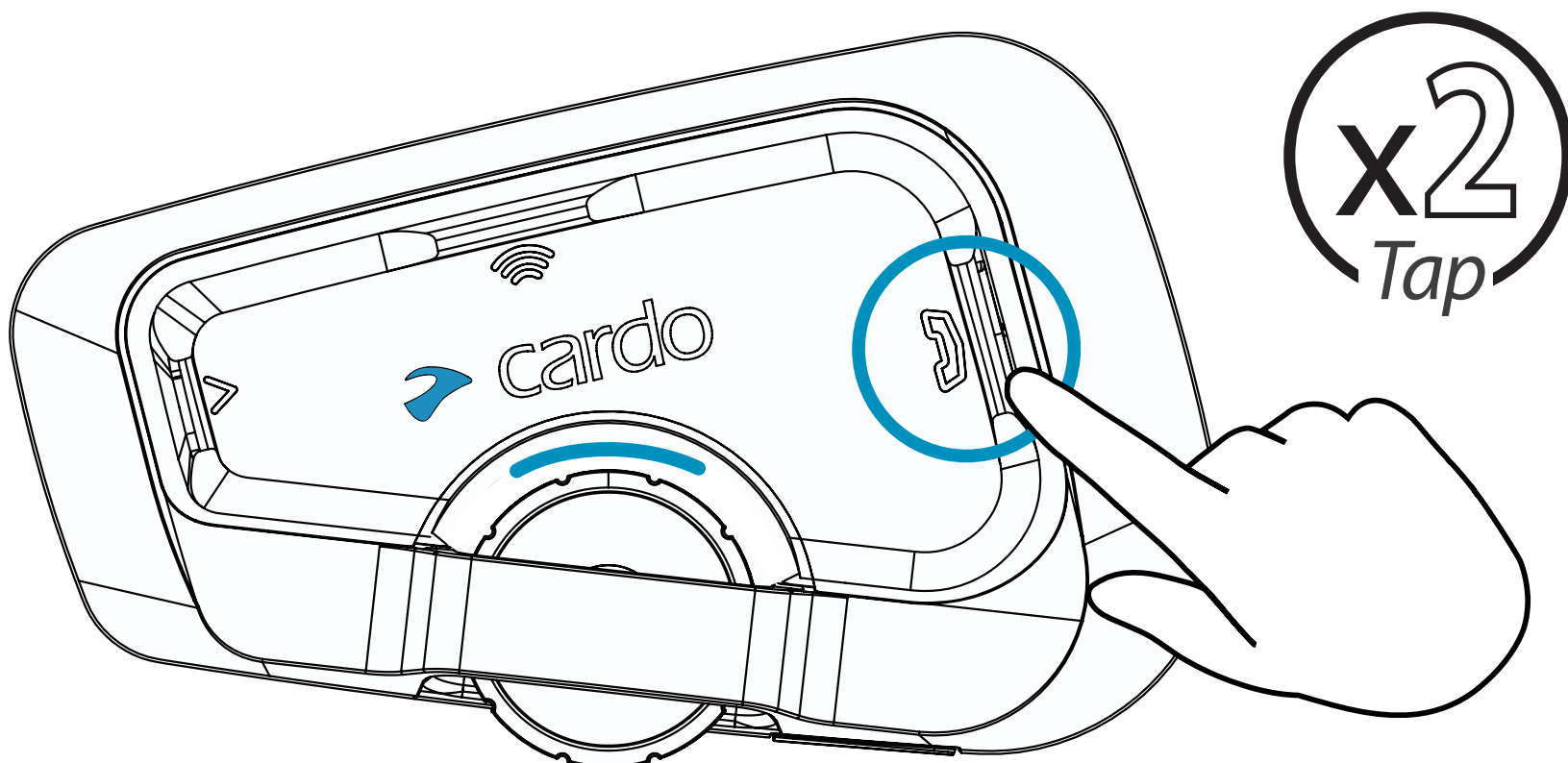

Bluetooth-Gegensprechanlage



Koppeln

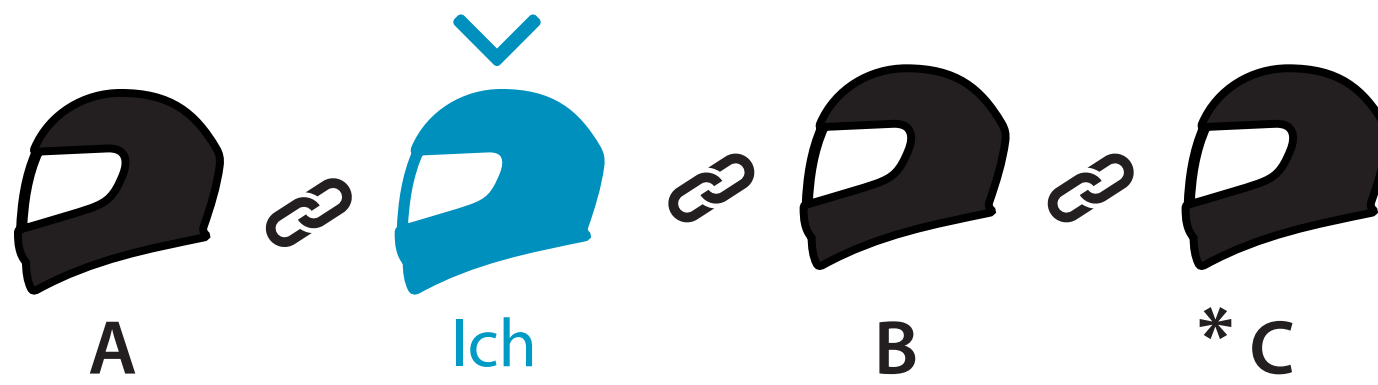

Koppeln mit Fahrer A

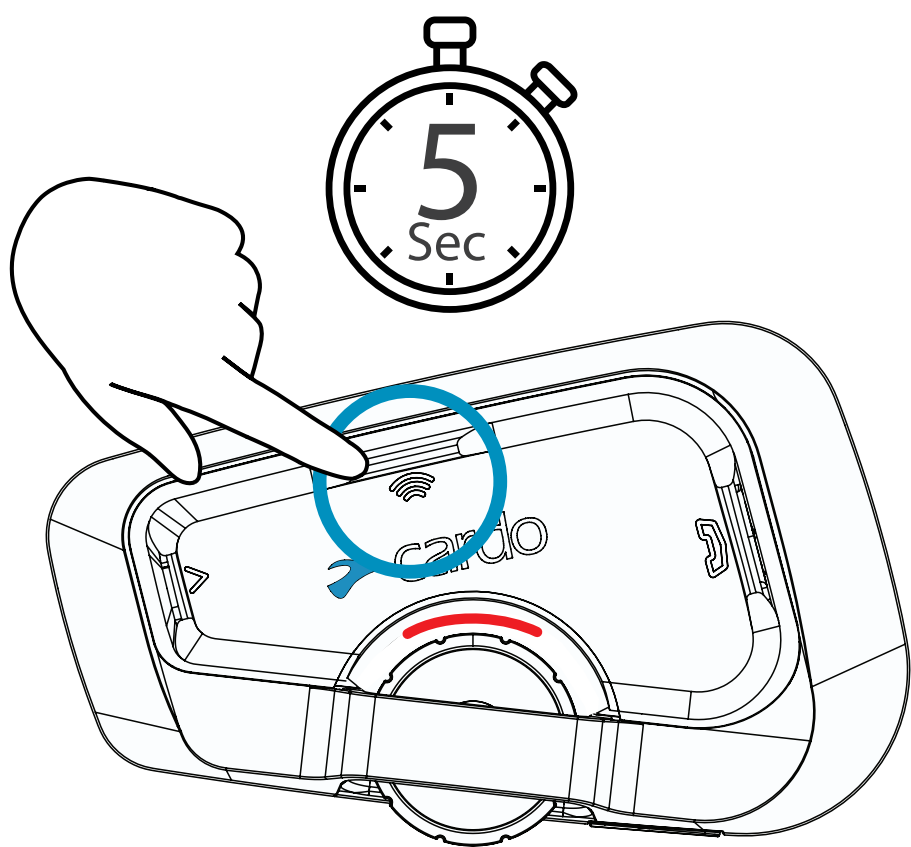

LED Rot



Koppeln mit Fahrer B

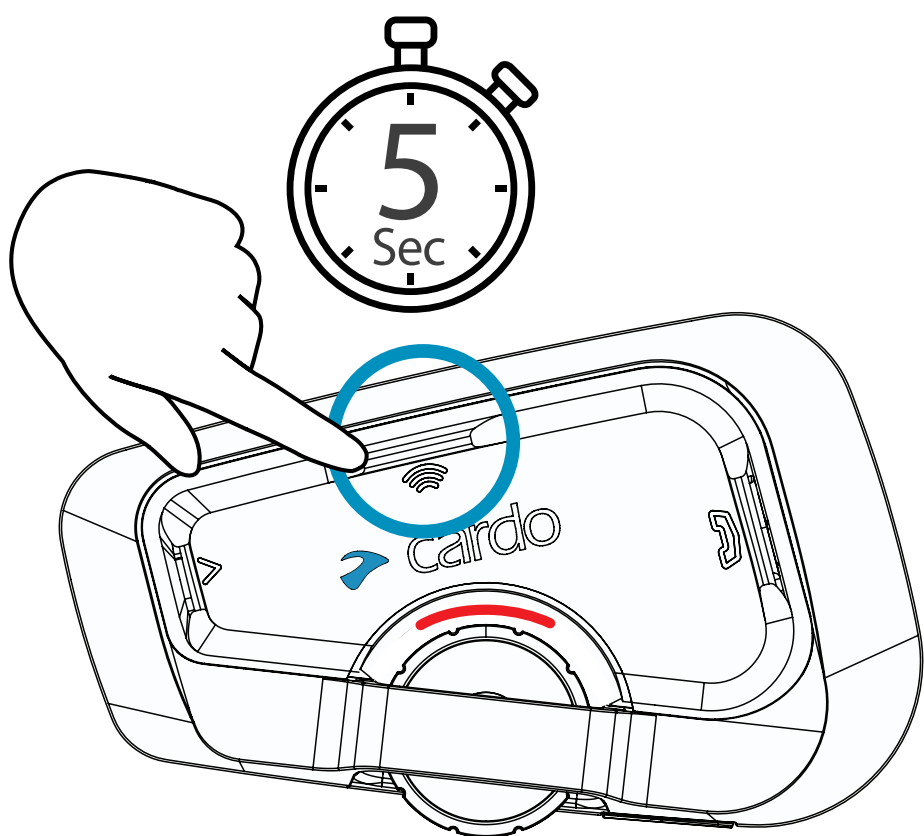

LED Rot

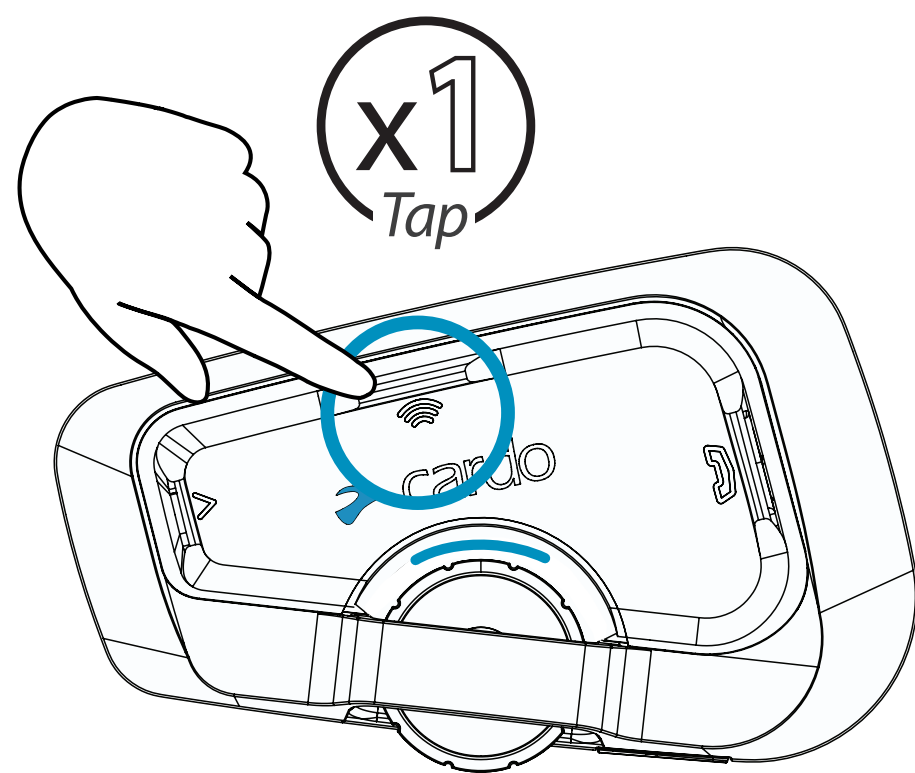

LED Blau



* Fahrer C sollte mit Fahrer B verbunden sein

Bluetooth-Gegensprechanlage



Gegensprechanlage rufen

Fahrer A

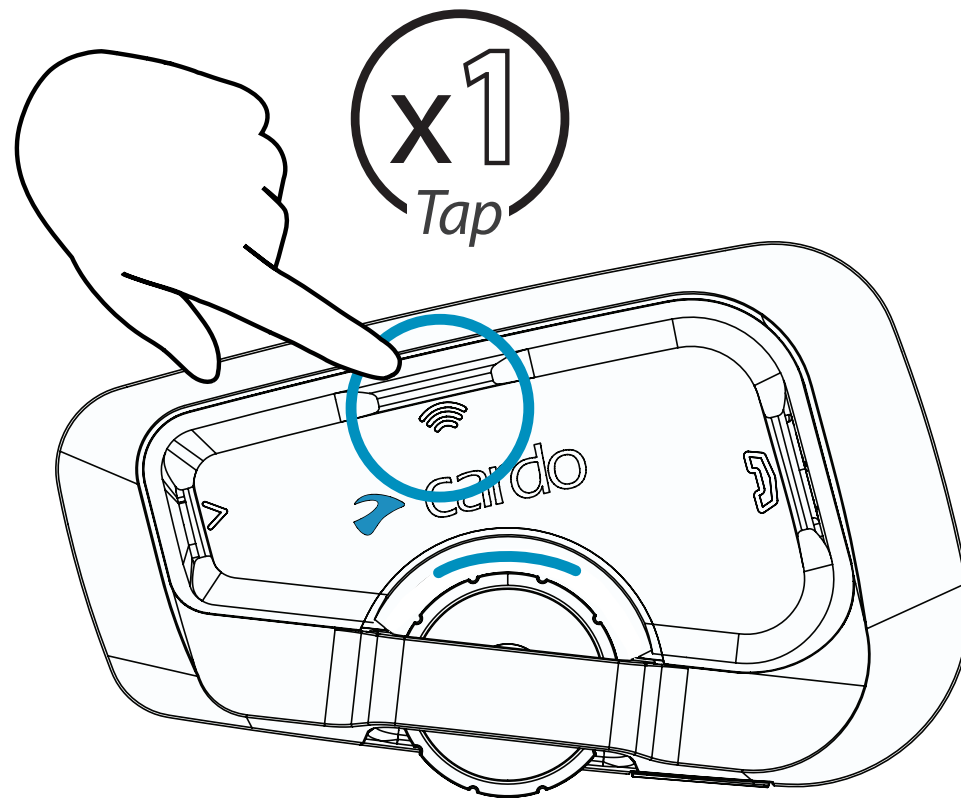

Fahrer B

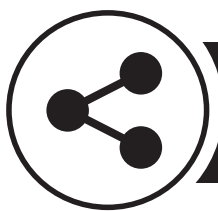
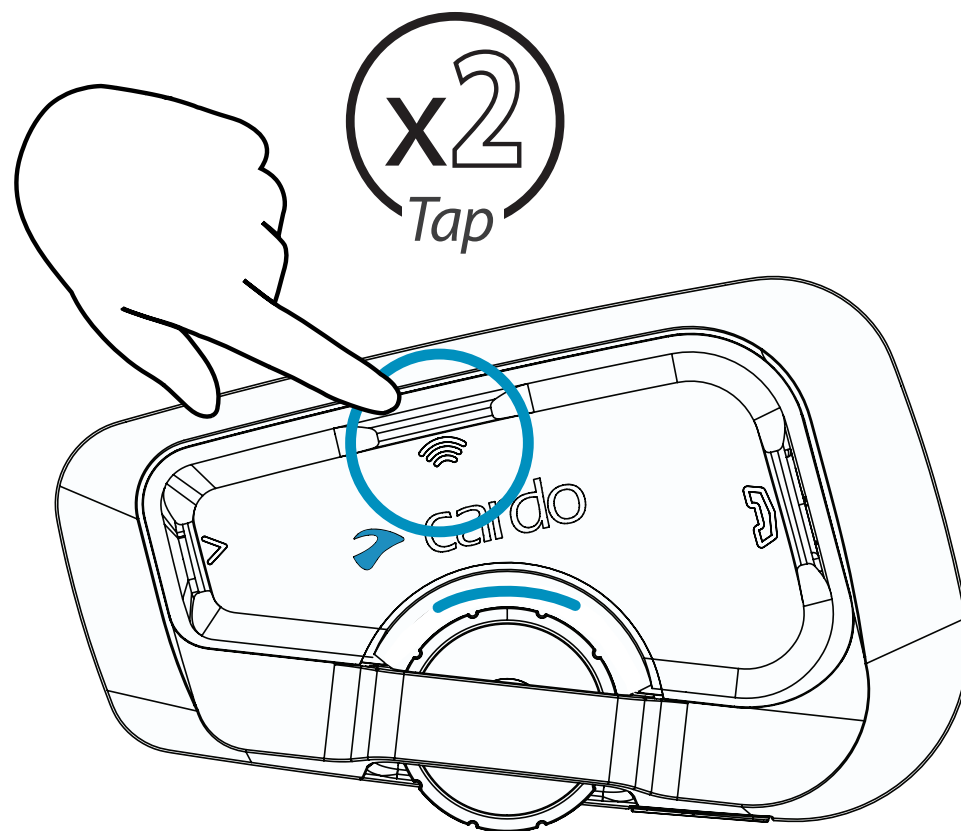

Freigeben



Musik freigeben

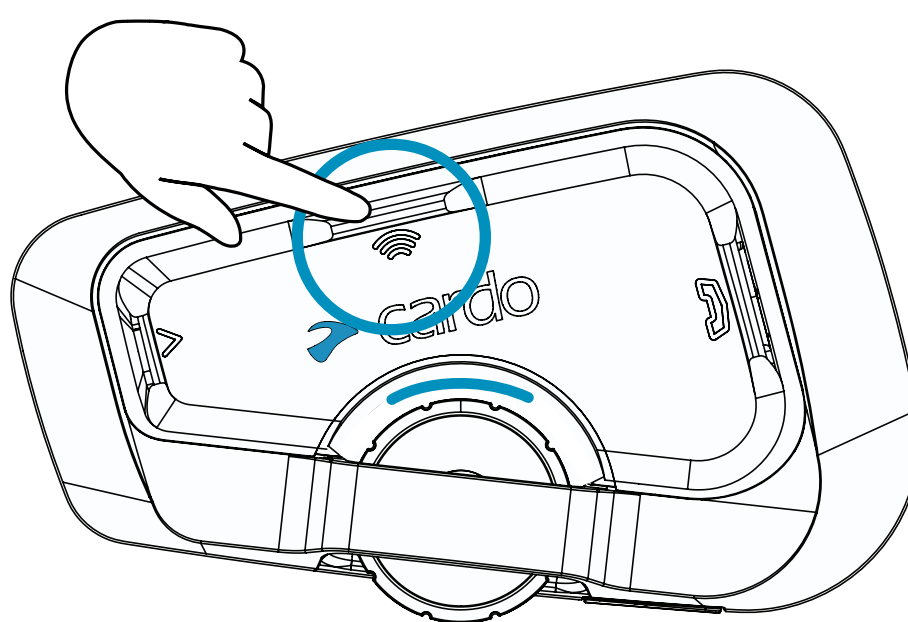

Telefongespräch freigeben

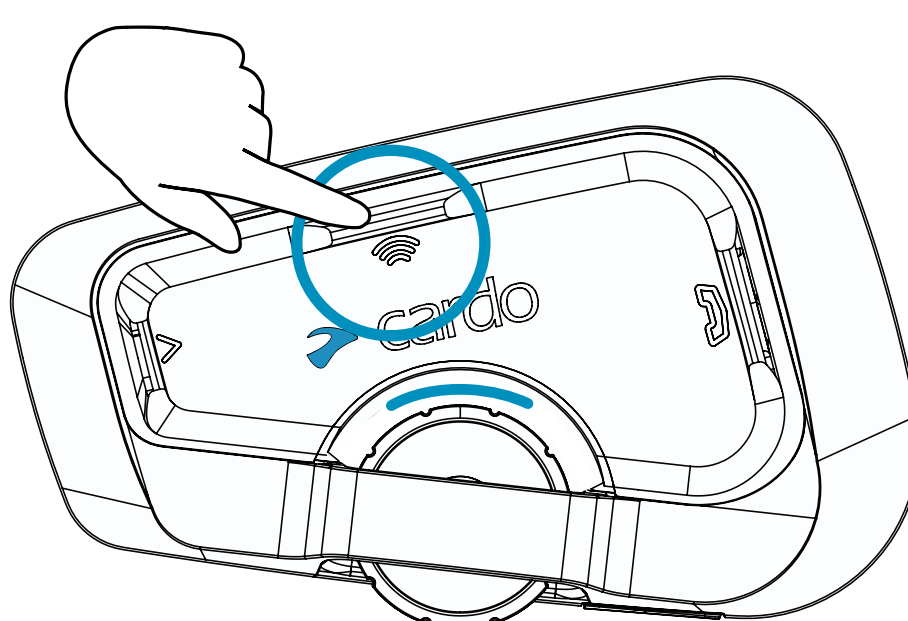
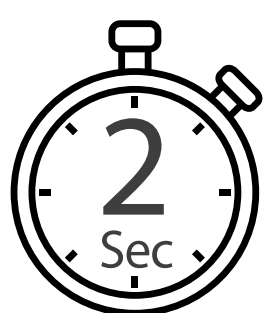

GPS-Kopplung

1 Schritt 1

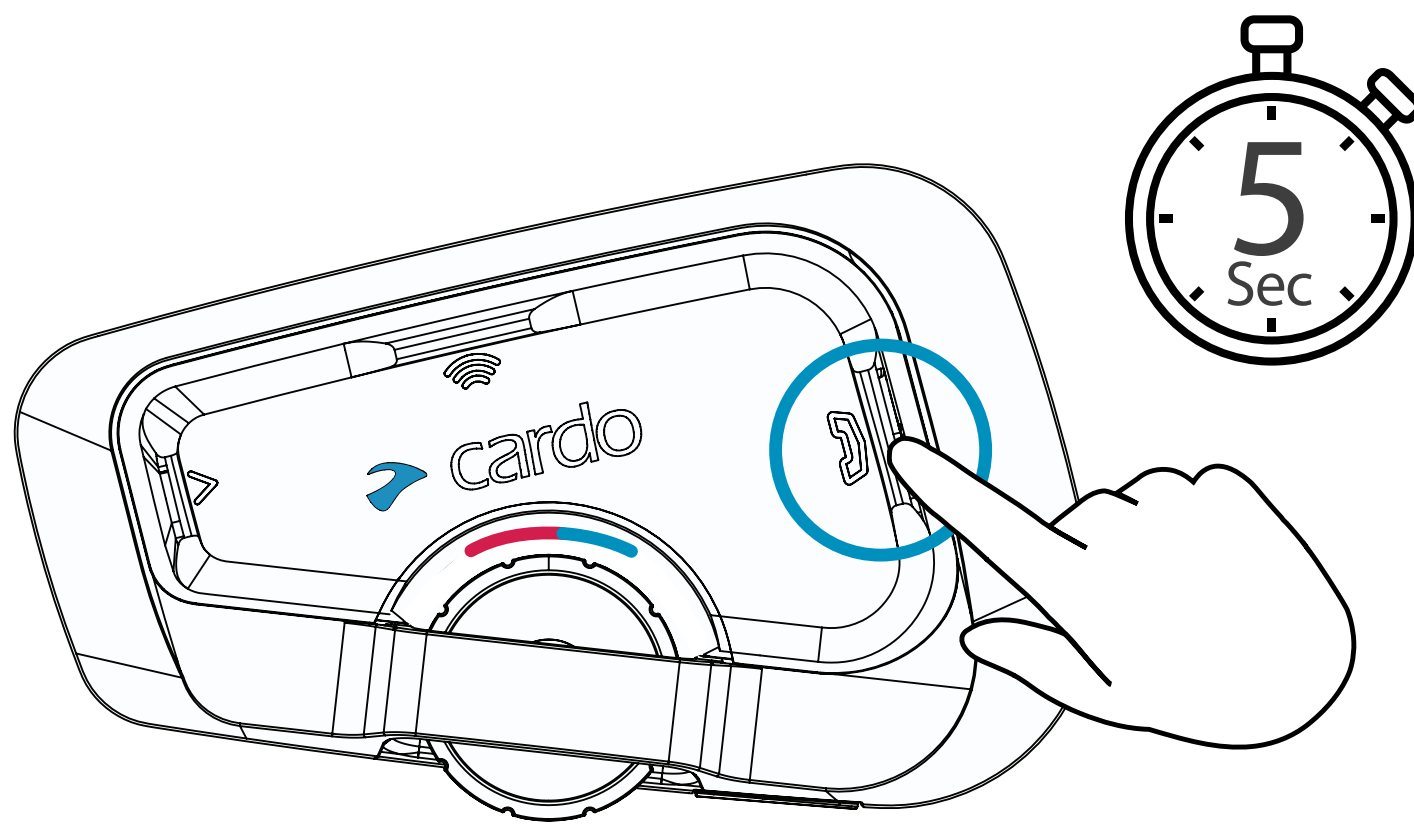

LED Rot und Blau



2 Schritt 2

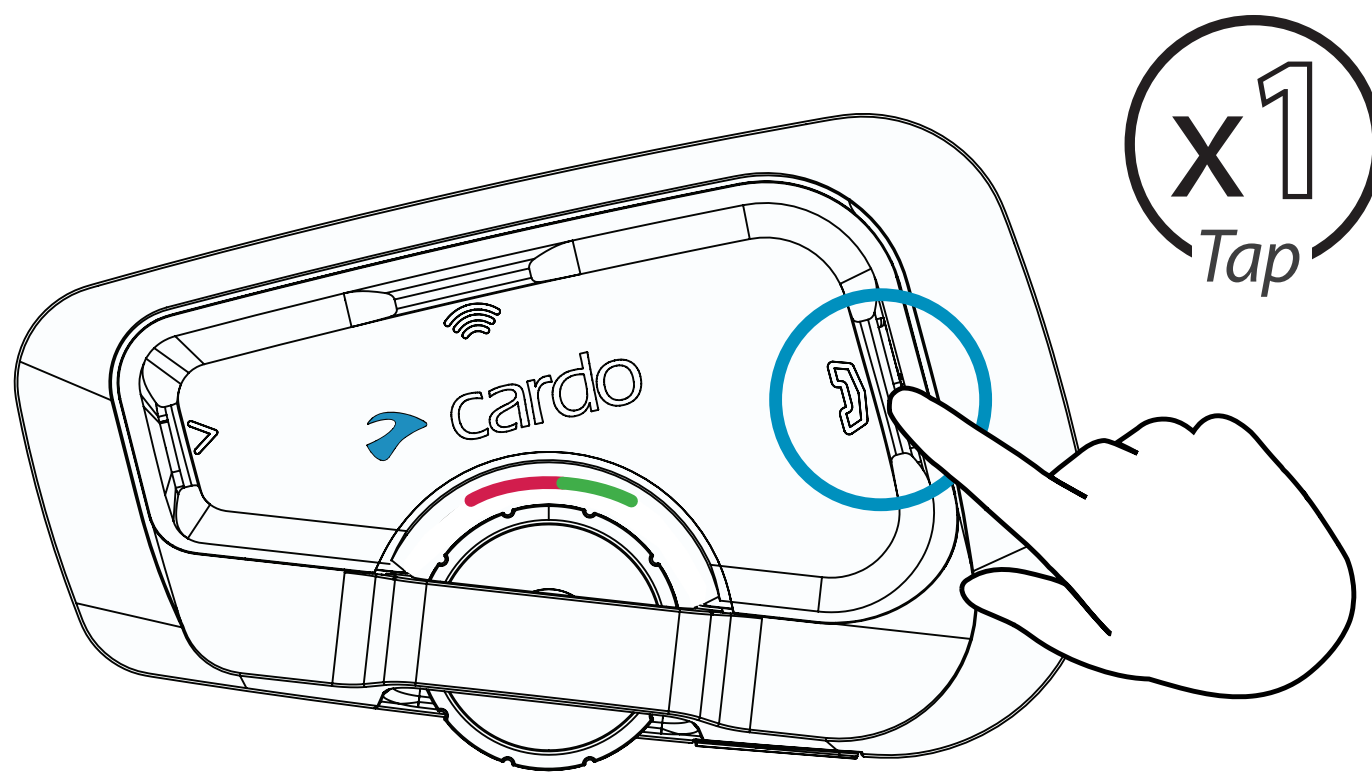

LED Rot und Grün



3 Schritt 3



Sprachbefehle – immer an!



- **Antworten**
- **Ignorieren**
- "Hey Cardo, **anruf beenden** "
- "Hey Cardo, **kurzwahl** "
- "Hey Cardo, **wahlwiederholung** "



- "Hey Cardo, **musik an** "
- "Hey Cardo, **musik aus** "
- "Hey Cardo, **titel vor**"
- "Hey Cardo, **titel zurück**"
- "Hey Cardo, **musik teilen**"



- "Hey Cardo, **radio an** "
- "Hey Cardo, **radio aus** "
- "Hey Cardo, **sender vor**"
- "Hey Cardo, **sender zurück**"



- "Hey Cardo, **interkom start** "
- "Hey Cardo, **Interkom stop**"



- "**Hey Siri**"
- "**Okay Google**"



- "Hey Cardo, **lauter**"
- "Hey Cardo, **leiser**"
- "Hey Cardo, **stumm ein**"
- "Hey Cardo, **stumm aus**"

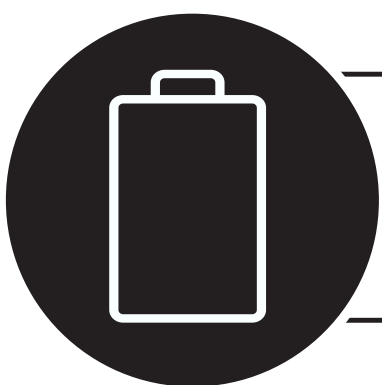

- "Hey Cardo, **Akkustatus**"

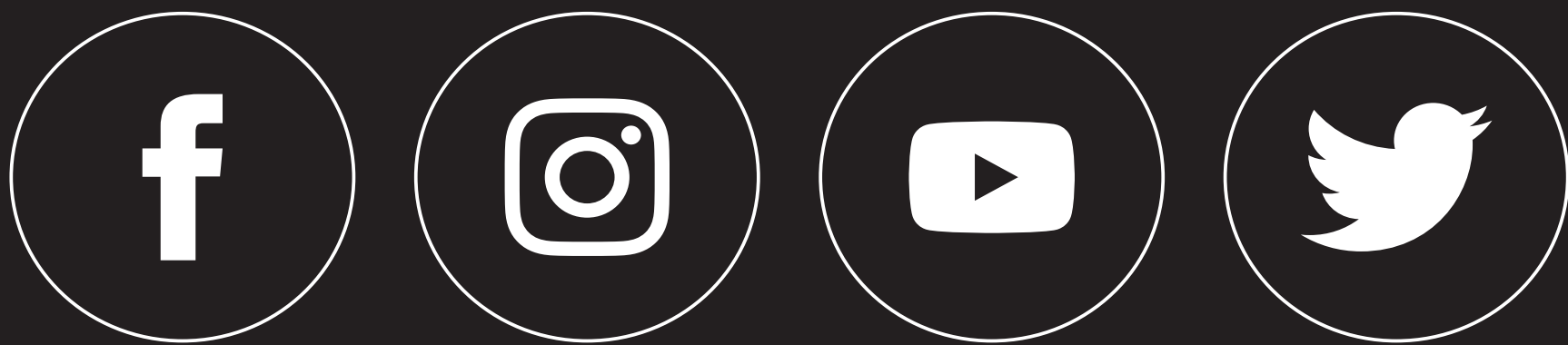

Cardosystems.com

Cardosystems.com/update

Cardosystems.com/support